

# Gramercy Medical Arts Building

380 Second Avenue @ 22nd Street



Join Gramercy Medical Arts' prestigious tenant roster including world renown medical and educational institutions including:

NYU Langone Health  
Hospital for Joint Diseases  
New York University  
School of Visual Arts  
East Side Endoscopy  
Gramercy Surgical Center

# ENTIRE 9TH FLOOR - 20,000 RSF (BASE PLAN)

East 22nd Street

Second Avenue

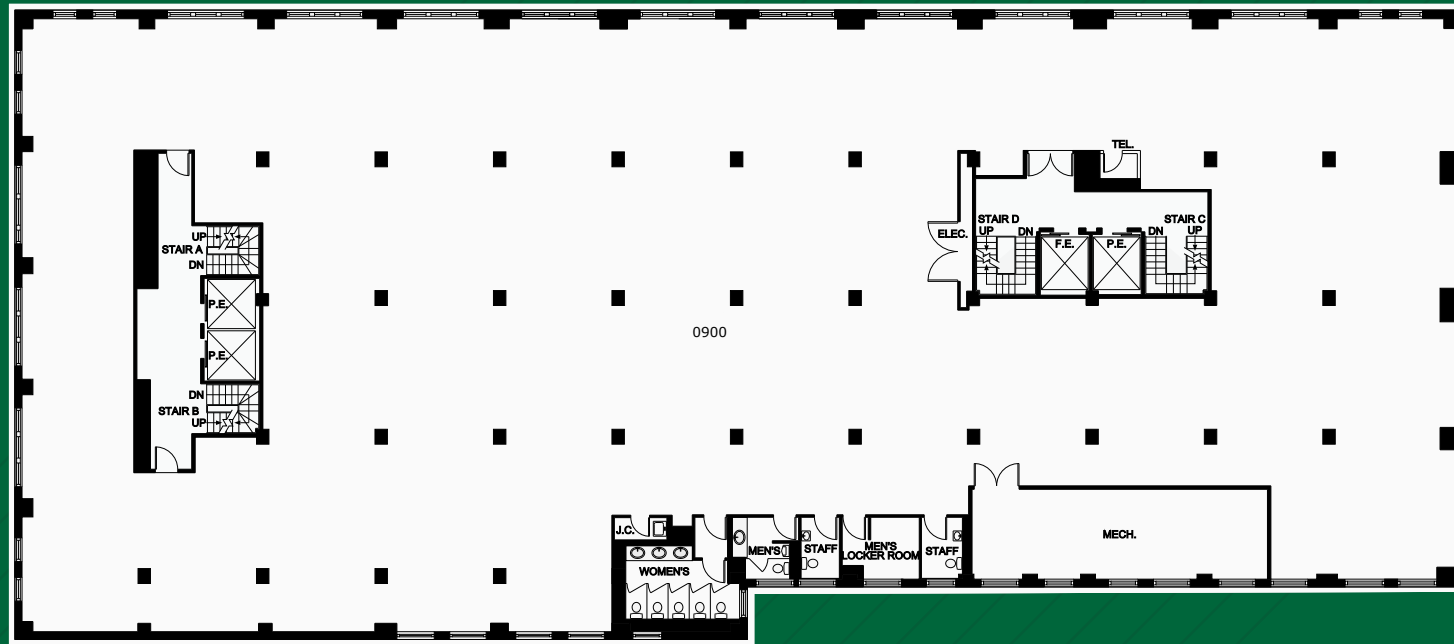

Available  
Entire 9th Fl: 20,000 rsf (may divide)

Possession Arranged  
Rent Call or email for details

Comments

- Landlord to deliver premises in white box condition, then build or contribute to new tenant installation for qualified tenant
- Excellent for medical or educational uses
- Tenant-controlled HVAC, loading dock available
- Second lobby located at 310 East 22nd Street undergoing expansion and renovation
- Long-term stable ownership

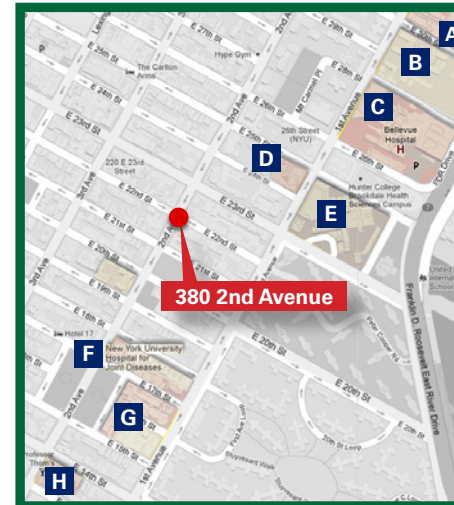

## AREA MEDICAL INSTITUTIONS

A	NYU Medical Center
B	Alexandria Center for Life Sciences
C	Bellevue Hospital
D	NYU College of Dentistry
E	VA Hospital
F	Hospital for Joint Disease
G	Beth Israel Medical Center
H	New York Eye & Ear