

# 15 WEST 37<sup>TH</sup> STREET



**FULL 4<sup>TH</sup> FLOOR**

**10,156 RSF SUBLEASE**

# 15 WEST 37<sup>TH</sup> STREET

## **SPACE FEATURES:**

Term through December 28, 2029

Immediate possession

Fully furnished & wired – move-in ready

## **Existing high-end installation featuring:**

- 6 private windowed offices
- 1 executive office
- 3 conference/showrooms
- 2 meeting rooms
- Pantry & reception area
- Open workspace for ±50 workstations
- FF&E included

# 15 WEST 37<sup>TH</sup> STREET

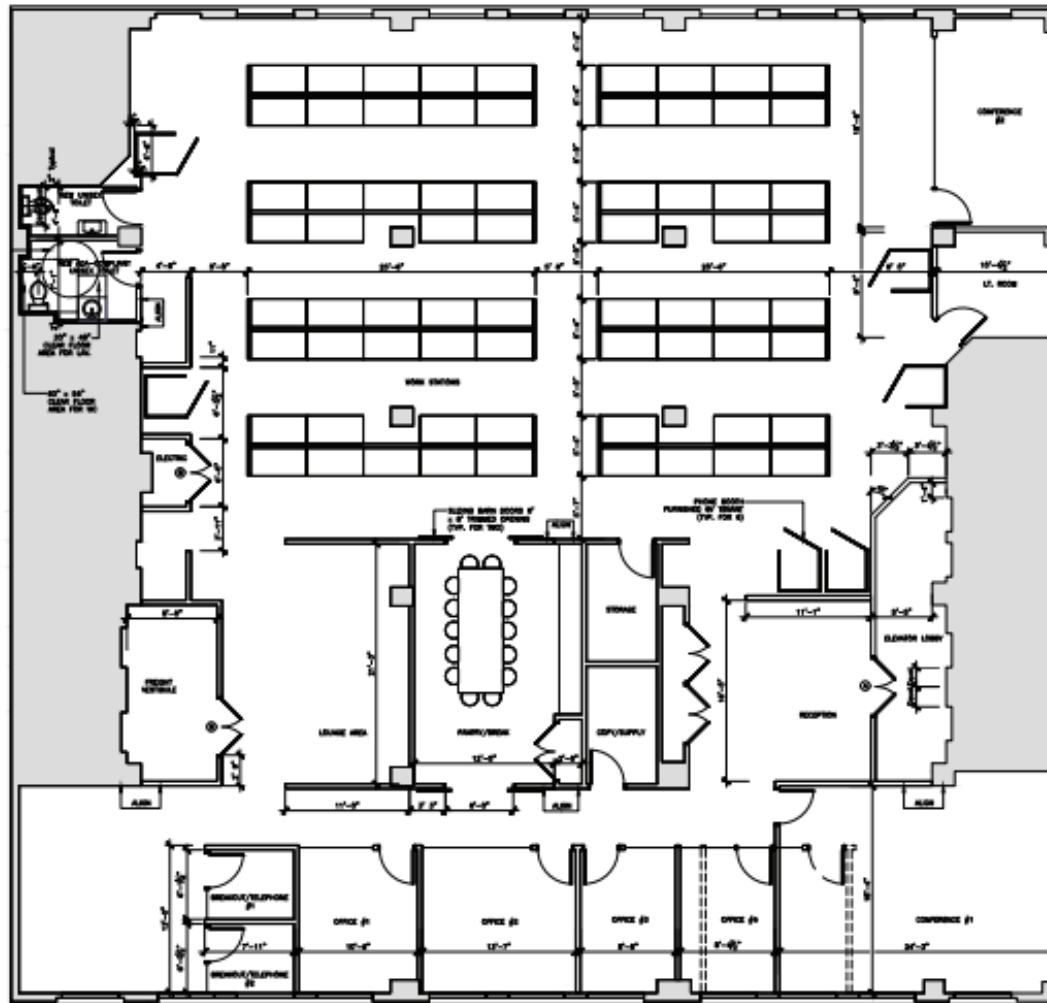

# 15 WEST 37<sup>TH</sup> STREET

