



# 888 Seventh Avenue

Newly Built, Plug-and-Play Sublease Opportunity

**Partial 5th Floor:** 10,315 RSF

**888 Seventh Avenue**

**Possession:** Immediate

**Sublease Term:** Through July 31, 2027

## ***Availability Details***

- Creative, high-end plug-and-play installation steps away from Central Park
- Space features 11 offices, 2 huddle rooms, 1 board room, 1 conference room, open area with 27 sit-stand workstations (ability to densify to 39) and a café style pantry
- Fully furnished and wired
- Building features on-site parking garage
- Supplemental AC in the server room
- Double door entrance with elevator presence
- Newly renovated corridors and restrooms

Partial 5<sup>th</sup> Floor: As-Built Plan

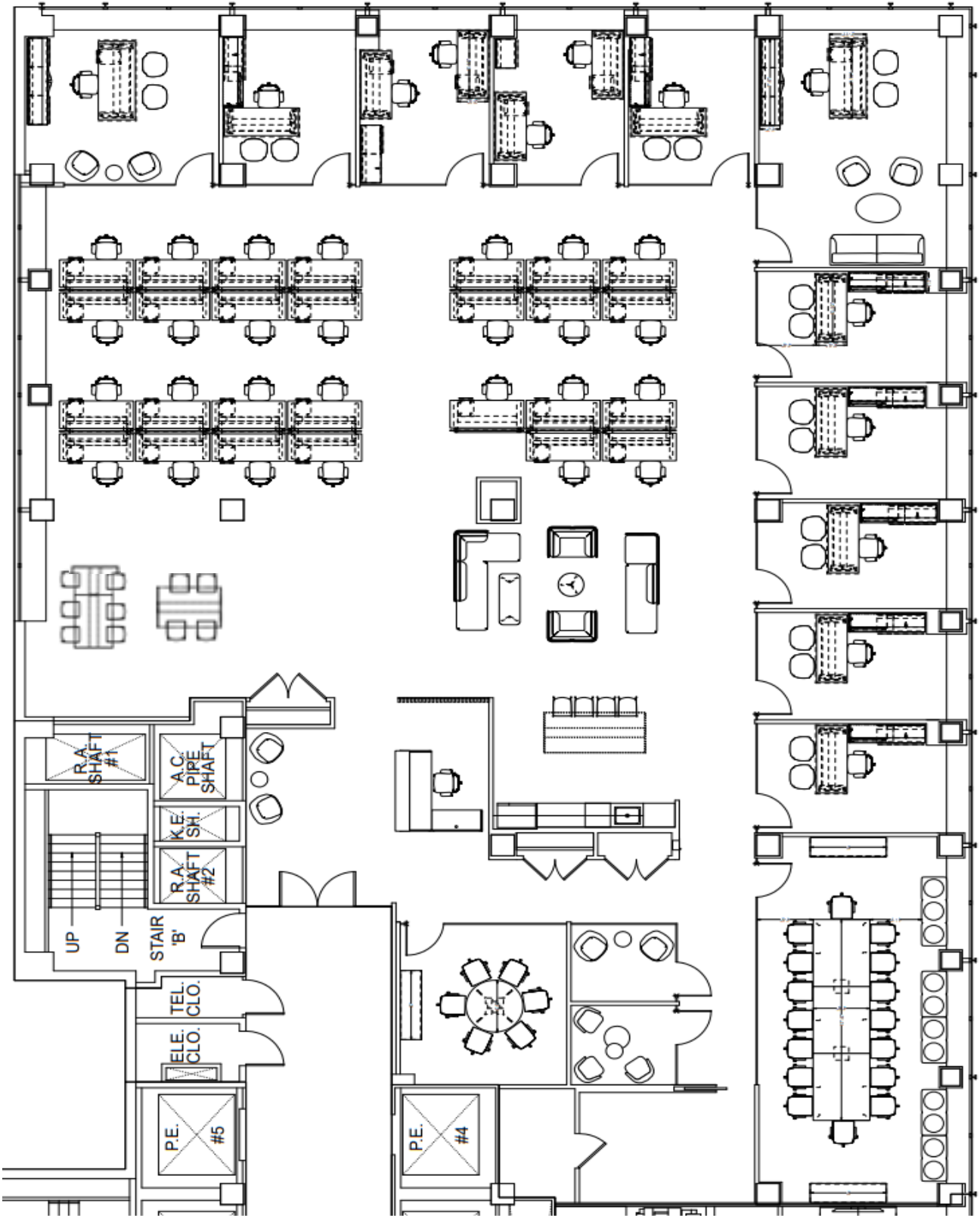



## Space Photos

