

# 450 Park Avenue

## *Newly Built Entire 28<sup>th</sup> Floor Available For Sublease*

**Pricing available upon request**

PRIME location at the center of Plaza District on Park Avenue and 57<sup>th</sup> Street

---

Space: **Entire 28<sup>th</sup> Floor**

Size: **10,796 RSF**

Term: **Through 12/30/2029 OR 12/30/2033**

Possession: **Arranged**

### **Installation Features:**

- Furniture available "plug and play space"
- Brand new installation with high end finishes
- 42 positions in bullpen
- 6 conference rooms totaling 82 seats
- Panoramic views
- Media wall
- Further details and floorplan on next page

### **Building Features:**

- Newly renovated lobby
  - Prominent Tenant Roster
  - Prime Plaza District Location
  - New Tenant Spa & Gym Amenity
  - Dramatic Park Avenue Views
  - Signature Curvilinear Windows
  - Steps to Central Park
  - Bike Facilities
  - Steps to the 4,5,6,F,N,R,W Trains
-

## Entire 28<sup>th</sup> floor as built plan

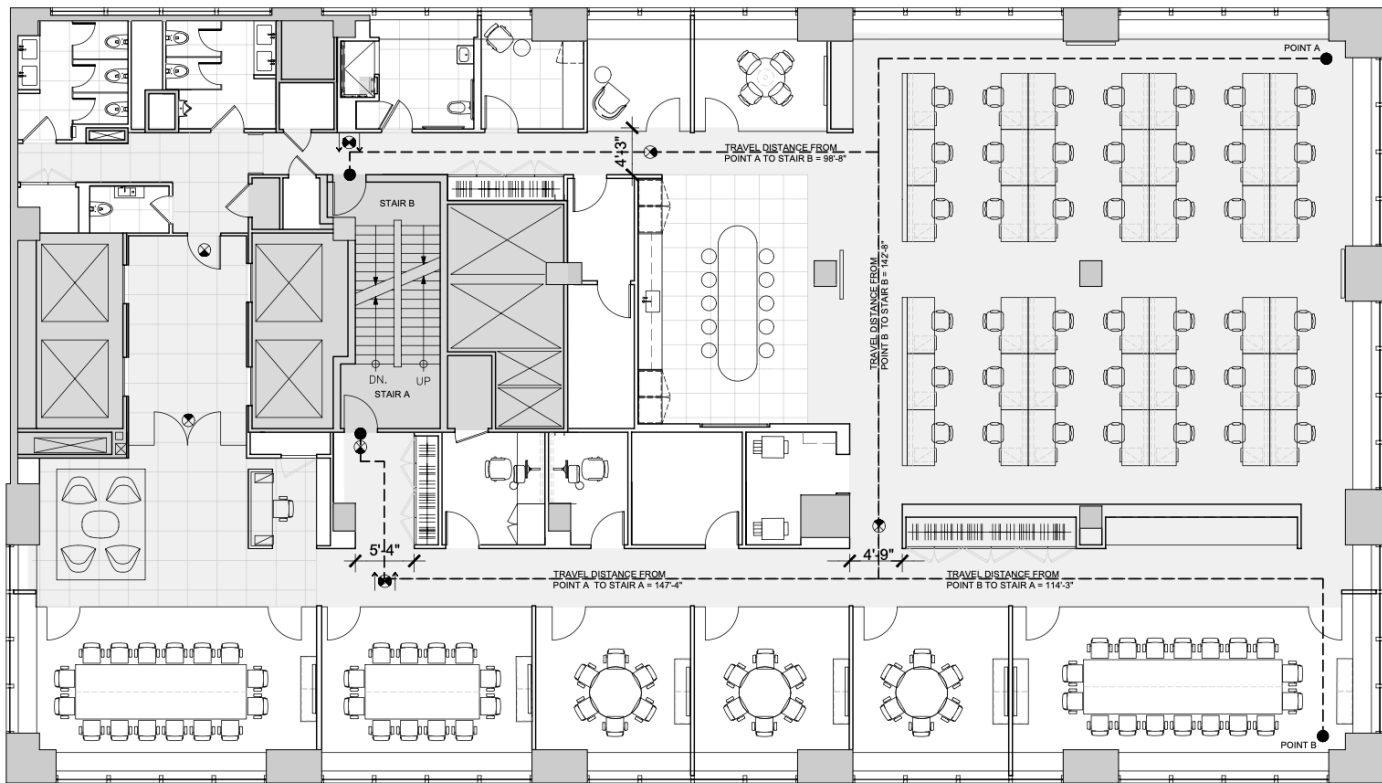

EAST 57TH ST.

PARK AVENUE



### Space Features:

- Reception Area
- 42 positions in bullpen
- 1 conference for 16
- 1 conference for 12
- 1 conference for 18
- 3 conference rooms for 6 each
- 1 huddle room for 4
- Large Pantry
- 2 internal offices
- 2 phone rooms
- 1 wellness room
- Men's / Women's restrooms and 2 private individual bathrooms, 1 with shower.
- 1 IT/IDF room
- 1 print/copy/storage room

