



For **sublease**

Park Avenue Tower Floor Sublease

101 Park Avenue, New York, NY 10178

SPACE PROFILE

Partial 38th floor –
12,282 SF

Premises

December 30, 2032

Term

Upon request

Asking Rent

Immediate

Availability

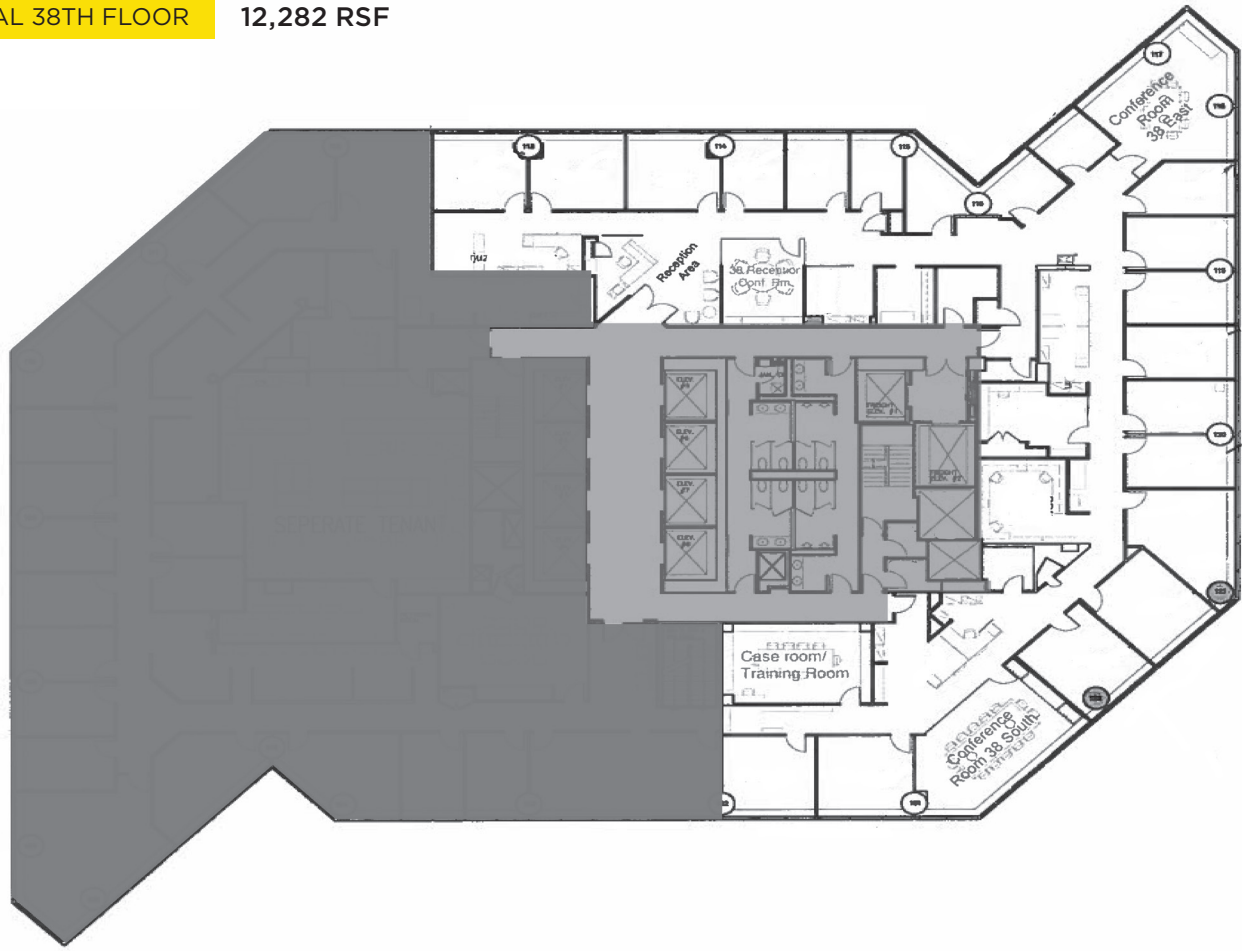

KEY HIGHLIGHTS

- Trophy-Quality Building
- Move-in Condition Sublease
- Stunning 360 degree views from Midtown to the Statue of Liberty
- Exclusive Club 101 Located in building
- 130 car garage in building
- Convene in building
- One block from Grand Central Station

SPACE OVERVIEW

- 10 perimeter offices
- 2 conference rooms
- 1 meeting room
- 10 workstations
- 1 pantry