

SUBLEASE AT

ONE

**GRAND
CENTRAL
PLACE**

60 EAST 42ND STREET



PARTIAL 14TH FLOOR | 15,675 RSF



SUBLEASE AT

ONE

GRAND
CENTRAL
PLACE

60 EAST 42ND STREET



Partial 14th Floor

Location

60 East 42nd Street, between Park and Madison Avenues at the base of Vanderbilt Avenue

Premises

Partial 14th floor - 15,675 RSF, Suite 1440

Possession

12/1/2025

Term

Through December 30, 2029

Rate

Available upon request

Space Description

- Move-in ready space in prime Grand Central location
- Fully furnished and wired
- Brand new installation
- Polished concrete floors
- Open finished ceilings

Building Description

- Located across from Grand Central Terminal on 42nd Street
- Recently completed upgrades to windows, elevators, plumbing, HVAC, security and restoration to lobby
- In-building amenities include a visitor center and tenants-only conference center and convenience store
- Several dining options such as 6b, Pera Mediterranean Brasserie and Blue Bottle Coffee as well as banking/investment companies such as JPMorgan Chase Bank, Charles Schwab and First Republic Bank

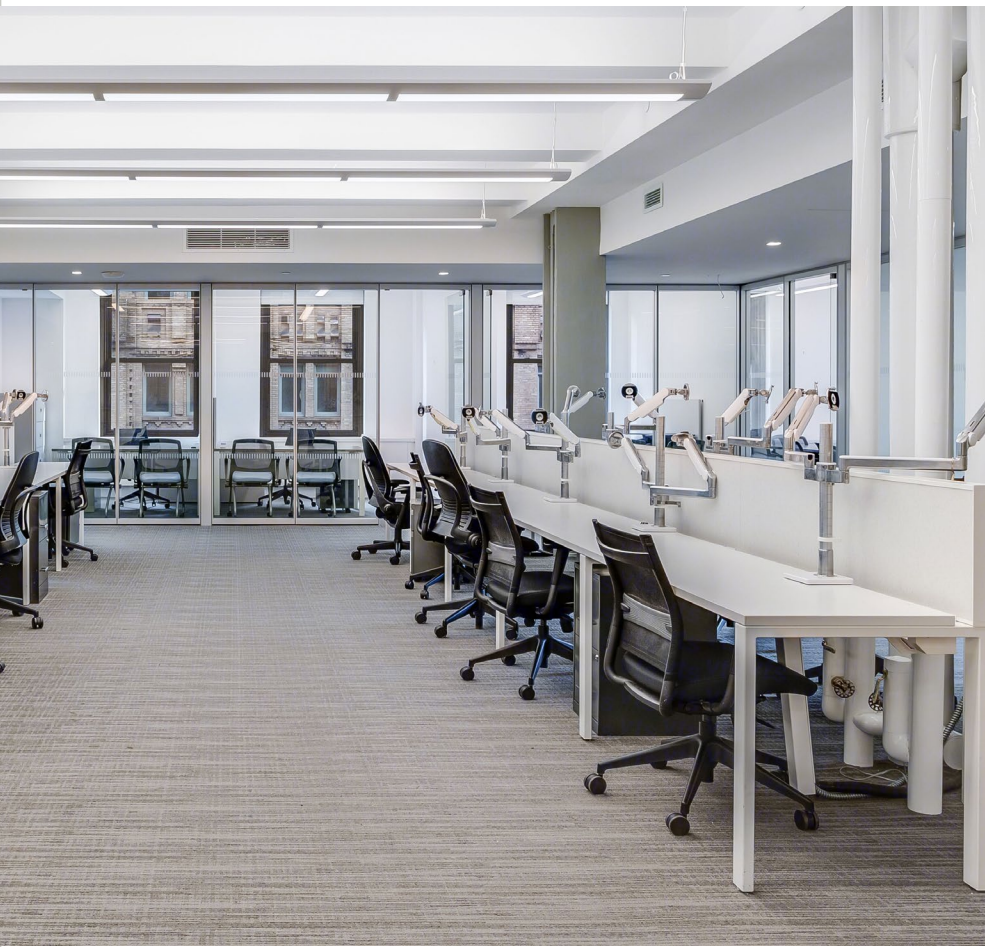

Layout

- 94 workstations
- One 12-person conference room
- Two 8-person conference rooms
- One 7-person team room
- 15 perimeter offices
- Three large breakout rooms
- Reception area
- Pantry

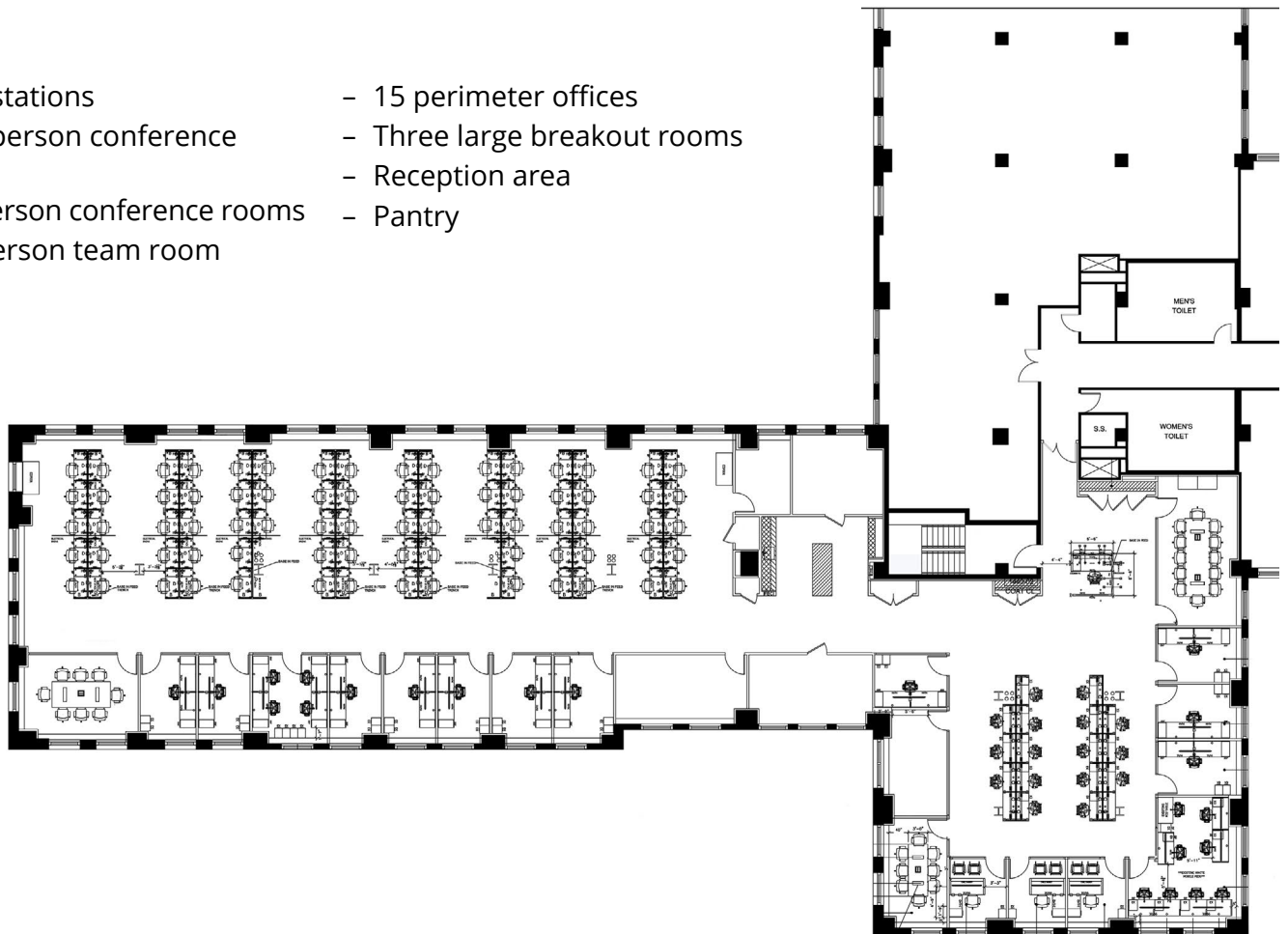

SUBLEASE AT

ONE

GRAND CENTRAL PLACE

60 EAST 42ND STREET



Nearby Transportation

Direct access to Grand Central Terminal which gives access to the

