

12 EAST 49TH STREET

Between Fifth Avenue and Madison Avenue

High-End Financial
Services Sublease
with High Ceilings &
360 Degree Views



Availability

- Entire 45th Floor
- 16,200 RSF
- Projected Delivery: March 2025
- Sublease Expiration: Sept. 2030
- Longer Term Direct Opportunity Available

Space Features

- 13'4" Ceilings & Panoramic Views
- Furniture Available
- Spectacular 360 Degree Views
- Creditworthy Sublandlord
- Air Conditioning with Unlimited Overtime Use

Building Features

- 16 High Speed, Energy Efficient, State of the Art Elevators
- 24-hour Concierge
- Amenity Center with Conferencing and Tenant Lounge
- Proximate to B, D, F, M, E & 6 Trains
- Across from Grand Central with Access to LIRR and Metro North
- Across from Saks Fifth Avenue, Rockefeller Center, and JP Morgan Chase Headquarters

12 EAST 49TH STREET

Between Fifth Avenue and Madison Avenue

Entire 45th Floor: 16,182 RSF

LARGE
CONFERENCE ROOMS

MULTIPLE
OFFICES

OPEN
DESK SPACES

KITCHEN AREA WITH
APPLIANCES

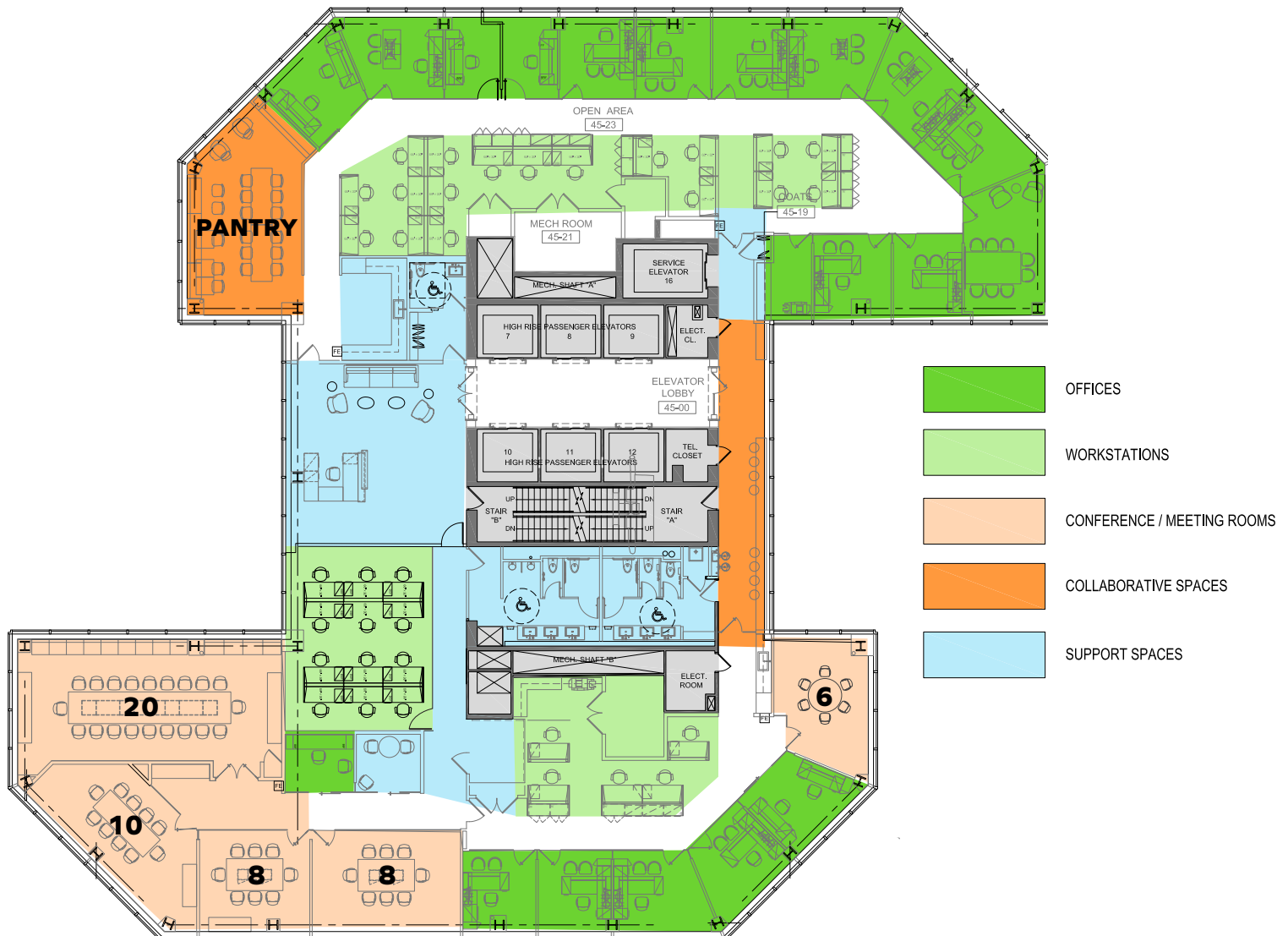

12 EAST 49TH STREET

Between Fifth Avenue and Madison Avenue

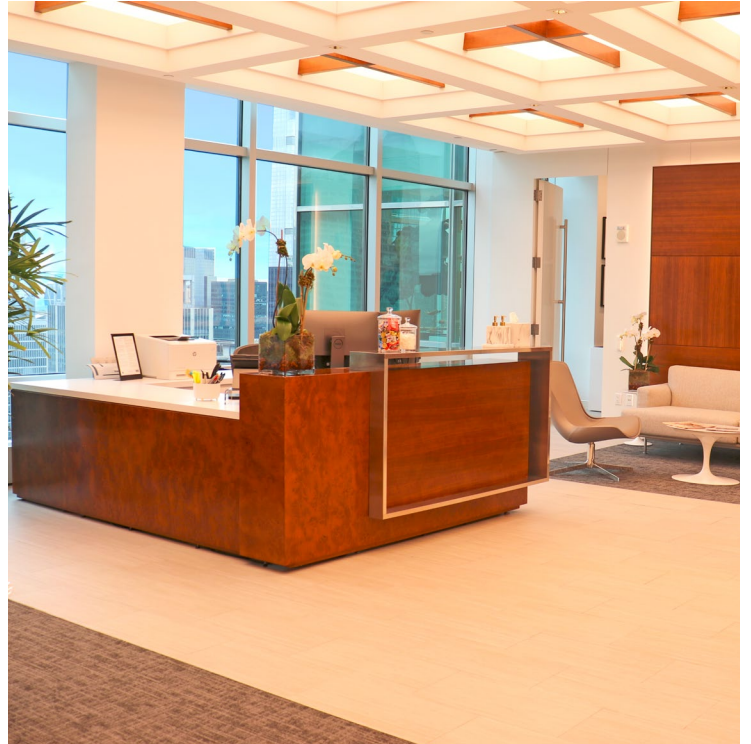

12 EAST 49TH STREET

Between Fifth Avenue and Madison Avenue

