

# TEXTILE BUILDING

295  
FIFTH

295  
FIFTH

**700,000 SF FULL-BUILDING  
OPPORTUNITY IN MIDTOWN SOUTH**



# VISION

It is our vision to transform this grand, 100-year-old asset into a world-class office building that combines the authenticity, charm and strength of the past with a newly-imagined lobby, state-of-the-art technology, and a range of amenities and outdoor spaces designed to suit today's leading tenants.

PENTHOUSE ROOF ADDITION AND TERRACE





# BUILDING

295 Fifth Avenue is a century-old full block building. It boasts abundant natural light, generous ceiling heights and full-floor, expansive spaces.

The building also offers outdoor spaces and two new construction penthouse floors affording sweeping city-wide views.

295 FIFTH AVENUE IS A FULL BLOCK BUILDING











BRAND-NEW LOBBY DESIGNED BY STUDIO MAI



# BUILDING

The design of these exceptional spaces fuses the grandeur and endurance of a century-old building with the sophistication and modern specifications of today's tenants.

TYPICAL OFFICE FLOOR

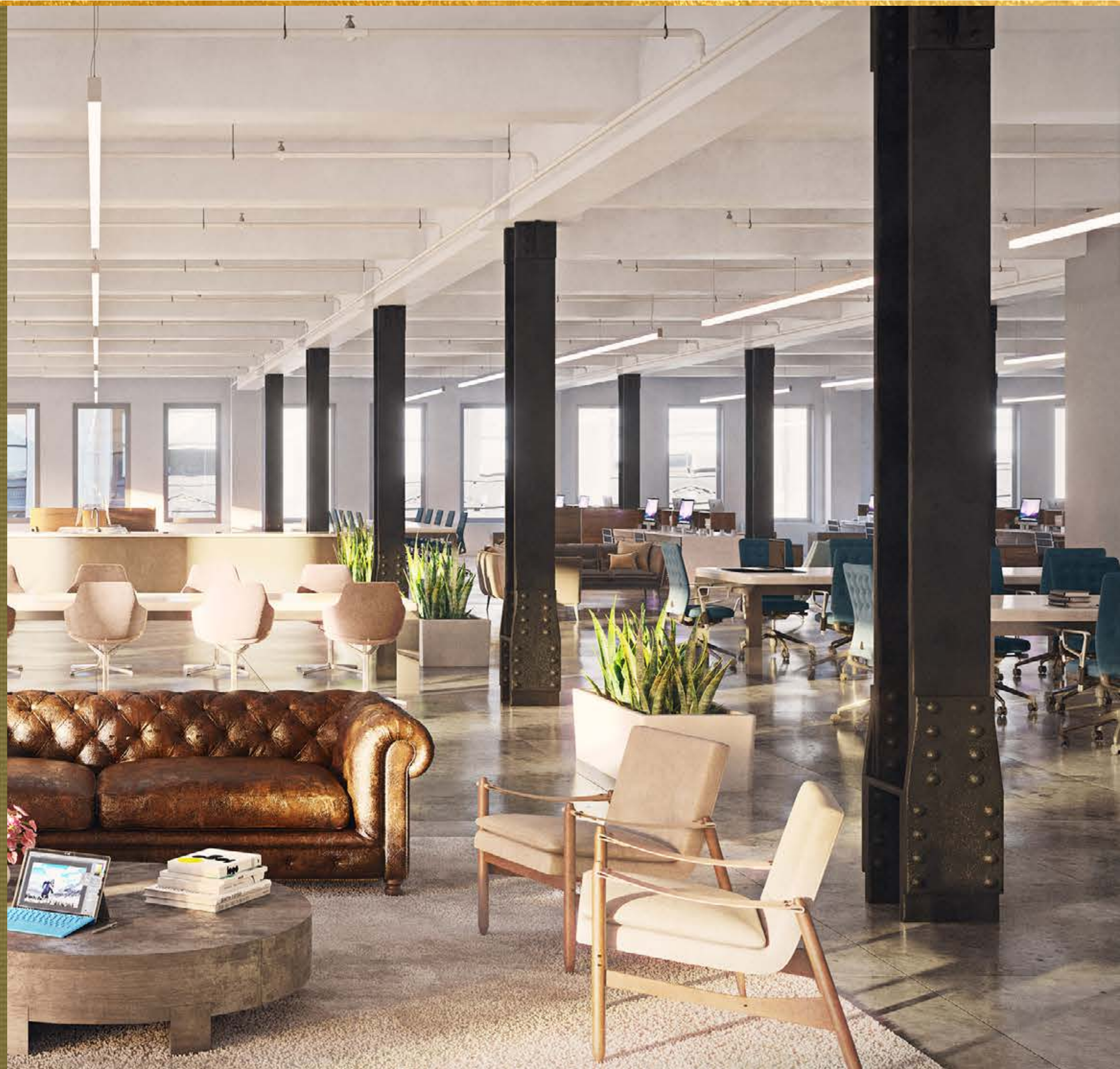





TYPICAL OFFICE FLOOR





TYPICAL OFFICE FLOOR



# HIGH RISE 11-16

## HIGH DENSITY TESTFIT

### 44,242 RSF

RECEPTION: 1  
WORKSTATIONS: 342  
PRIVATE OFFICE/HUDDLE: 19  
CONFERENCE ROOM SEATS: 105  
SF/PERSON: 125 SQ FT

- RECEPTION
- OFFICE/HUDDLE ROOM
- LOUNGE
- CONFERENCE ROOM
- PANTRY

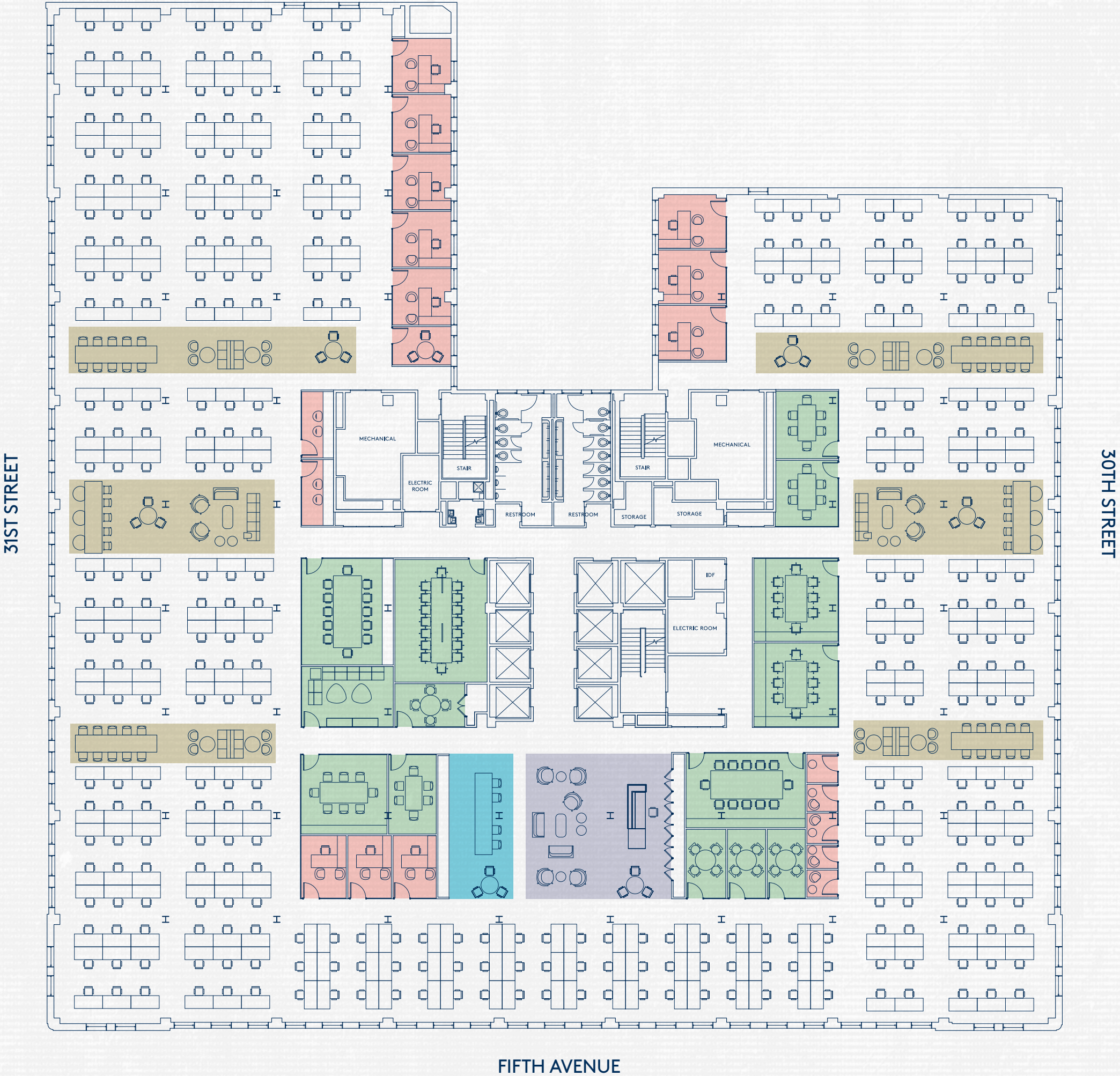



# AMENITIES

295 Fifth Avenue offers amenities tailored for what tenants really need. Places to collaborate. A conference room for company town halls, or movie nights. Places to relax. Places to gather or to find some space.

With carefully-designed indoor and outdoor spaces as well as an activated lobby designed to inspire productivity, this building buzzes with energy while also providing moments of sanctuary when needed.

295 Fifth Avenue has parking for over 70 bikes.







LUSH PRIVATE COURTYARD AREA FOR EXCLUSIVE TENANT USE



# RETAIL

The two retail spaces at 295 Fifth Avenue each occupy a highly visible flagship corner at the base of a fully-renovated office building in the heart of NoMad. This is an architecturally unique building which stands adjacent to many of New York's most desirable restaurants, retailers and hotels.





# NEIGHBORHOOD

295 Fifth Avenue is situated in Midtown South, just north of Madison Square Park. It is a richly textured neighborhood with abundant transportation connections, and plentiful restaurants and bars ranging from white tablecloth to grab and go, lunch and coffee options.





# GALLERY



TYPICAL OFFICE FLOOR









AMENITY SPACE





PENTHOUSE ROOF ADDITION AND TERRACE





TYPICAL OFFICE FLOOR