

546 Fifth Avenue
N/W/C of Fifth Avenue & West 45th Street



For Sublease

Area	Partial 20 th Floor: 2,775 RSF
Rental Rate	Upon Request
Possession	Immediate
Term	2-5 Years

Space Comments

- Full term through June 2030
- Built with 1 conference room, 2 offices, and open area for 12
- Great natural light
- 12' exposed ceilings
- Close proximity to Grand Central Station, Port Authority, Bryant Park and the 1/2/3/4/5/6/7/N/Q/R/W/B/D/F/M Subway Lines
- Furniture can be made Available
- Direct Elevator Presence

PARTIAL 20TH FLOOR: 2,775 RSF

As-Built Floor Plan

RECEPTION	1
OFFICES	2
WORKSTATION	12
CONFERENCE ROOM	1

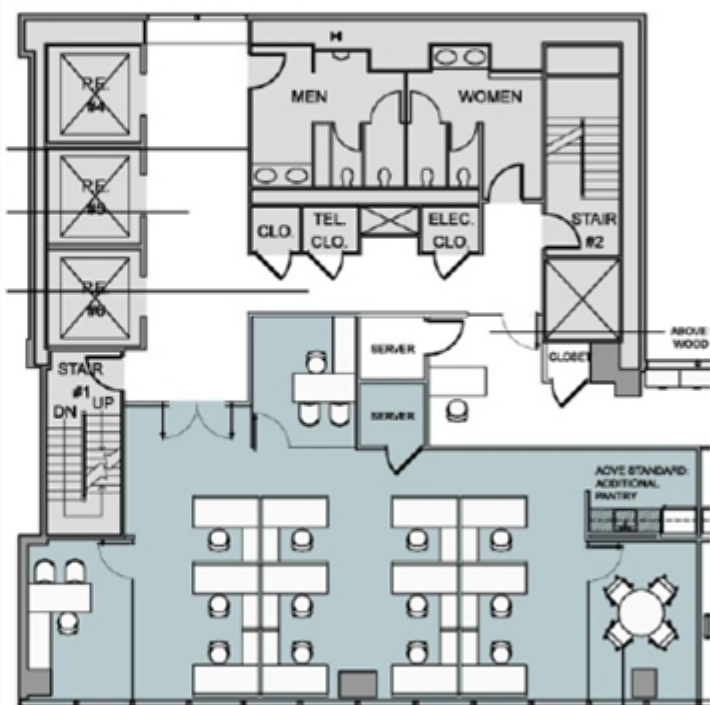

PARTIAL 20TH FLOOR: 2,775 RSF

Space Photos

