

TOWER 52



MIDTOWN'S  
BEST KEPT SECRET





# ELEVATE YOUR BUSINESS



**Tower 52** is a remarkable 35-story Class-A office tower located in the prestigious **Plaza District**.

**Tower 52** boasts a striking glass cube entrance, with a lobby that seamlessly integrates stone, glass, and wood materials throughout. The latest addition is a 6,000 SF amenity center with a beautiful 3,000 SF usable terrace, the perfect location to connect and collaborate with colleagues and clients.



# SOPHISTICATED SPACIOUS STUNNING



- 3,000 SF usable terrace
- Coffee bar
- 20-person board room
- Pantry with bar and table seating
- Lounge areas for large and small groups







LOUNGE



PANTRY







REJUVENATE,  
COLLABORATE & ENGAGE

LOUNGE 5  
4





# STANDARD FINISHES



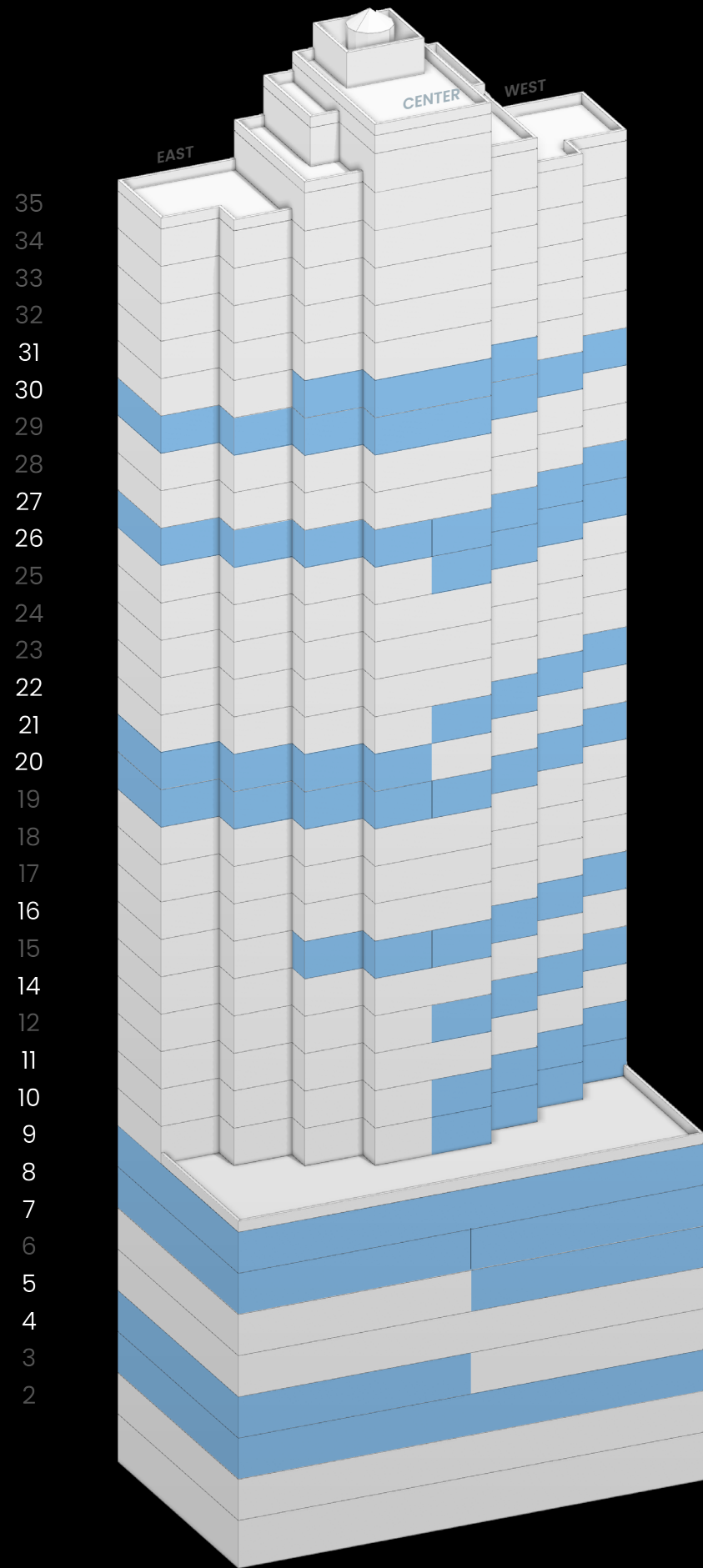

FLOOR      RSF      CONDITION      CONFIGURATION

P27<sup>W</sup>    2,845    2ND GEN    2 OFFICES • 2 CONFERENCE ROOMS • OPEN AREA FOR 12 • PANTRY



# PARTIAL 27th FLOOR

As-Built

2,843 RSF

- OFFICES 2
- WORKSTATIONS 12
- TOTAL HEADCOUNT 14
- CONFERENCE ROOMS (10PPL)
- PANTRY
- RECEPTION
- IT ROOM
- COAT CLOSETS

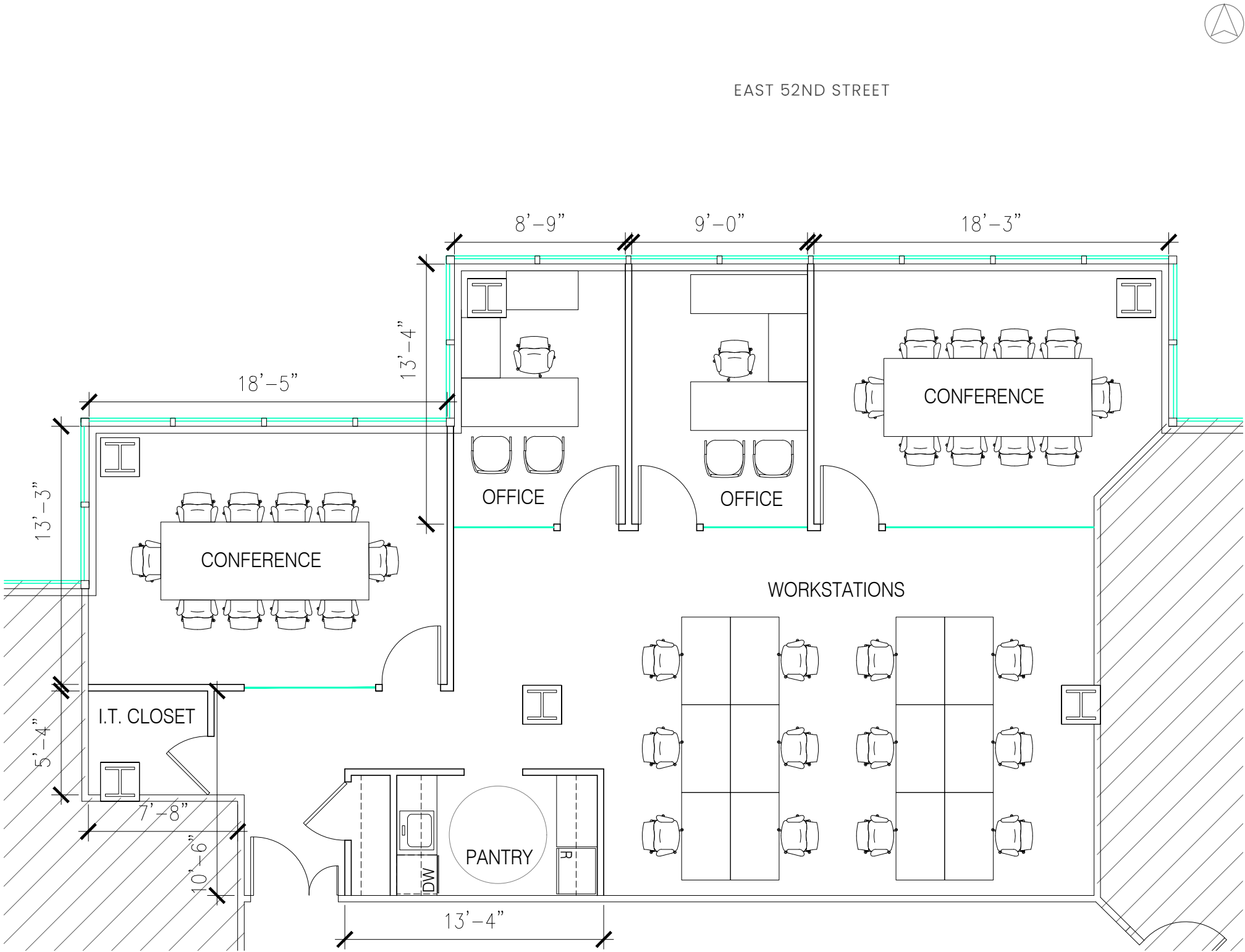



# CONVENIENT COMMUTES

