

FOR LEASE

253 Church Street

TRIBECA
NEW YORK, NY



253 CHURCH STREET

Property Details

Location

East block between Leonard and Franklin Streets

Approximate Size

Fourth Floor Duplex 2,896 RSF

Frontage

50 FT on Church Street

Term

Negotiable

Possession

Immediate

Site Status

Vacant

Rent

Upon Request

Neighbors

James Perse, Zadig & Voltaire, Almine Rech Gallery, Billy’s Bakery, Aire Ancient Baths, Tracy Anderson Method, Casa Carmen, Roxy Hotel, Two Hands Cafe, Galerie 56, Ted Muehling and Studio Twenty Seven

Comments

Distinctive, move-in ready space ideal for a gallery, showroom, creative office or fitness/wellness user

Lower duplex level has 50 feet of windowed exposure, upper duplex level has 6 windows on two exposures

Full pantry and high-end bathrooms on both floors with showers

Located in the epicenter of the burgeoning East Tribeca Art and Design District.

Distinctive space with hardwood floor and tin ceiling

Trendy Tribeca location one block from the 1 train and two blocks from **A C E**

Fourth Floor Duplex

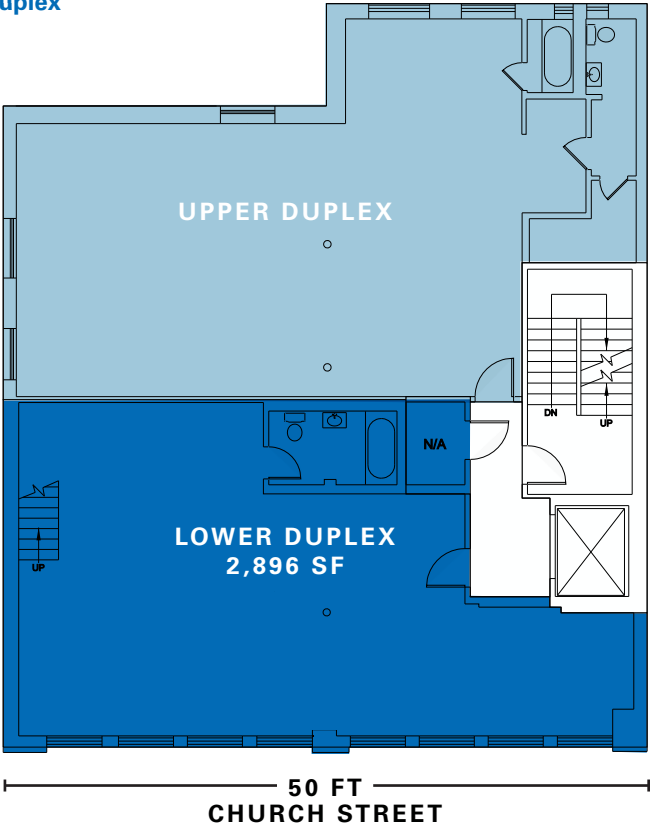

253 CHURCH STREET

Interior Photos



253 CHURCH STREET

