

WERE REATED FOR EXP AND/OR FIRE SAFETY LING I SC SHOULD BE USED FOR STRU EXISTING ONDOTI

Broadway

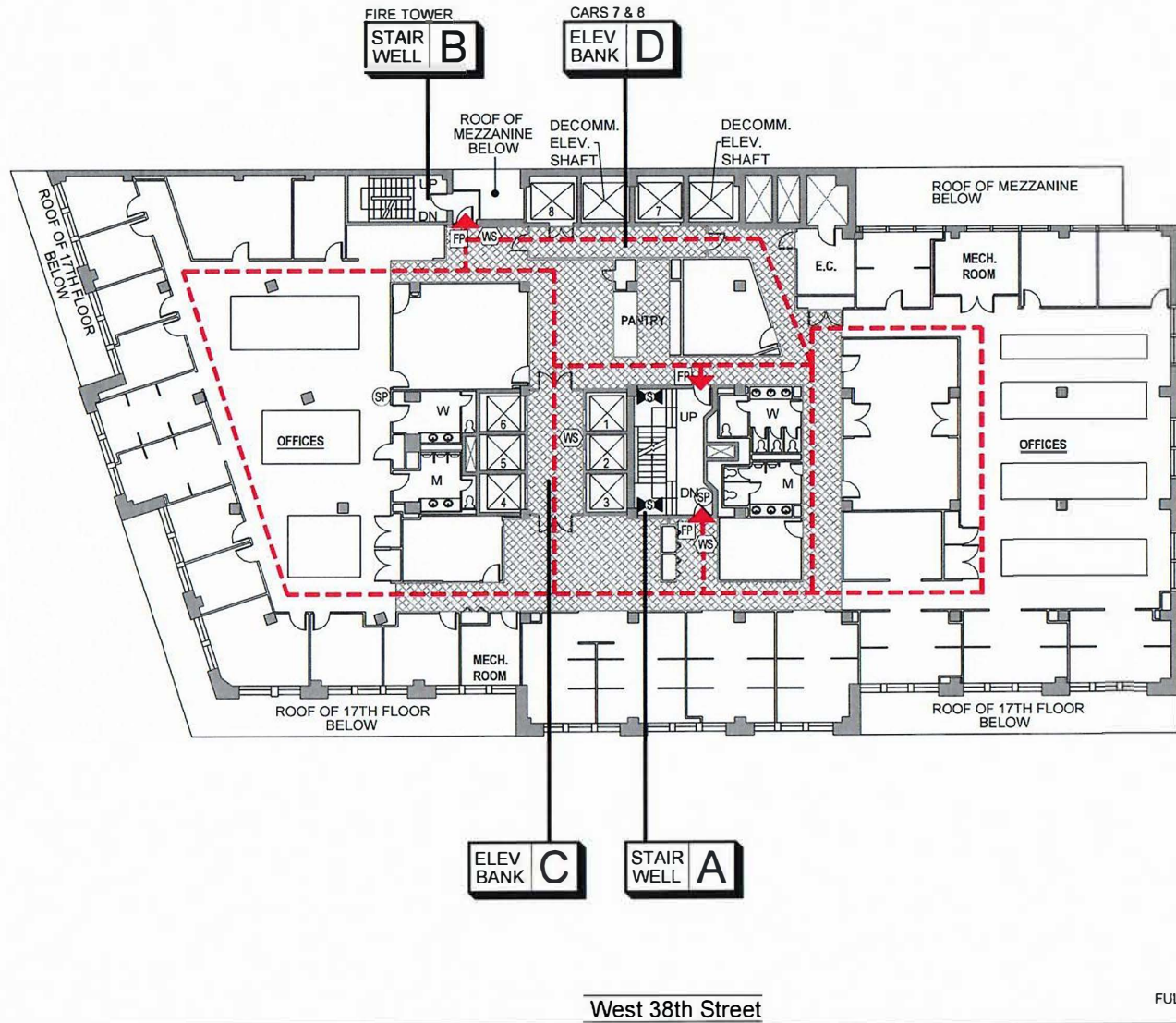

LEGEND

- FP Fire-Alarm Pull (FP)
- SP Standpipe (SP)
(with or w/o a hose)
- WS Warden Station (WS)
(Fire phone or phone jack)
- FCS Fire Command Station (FCS)
(See 1st Floor)
- Fire Dept. Connection
(See 1st Fl. & Site Plan)
- SV Sprinkler Valve (SV)
- SPV Standpipe Valve (SPV)
- DWSV Domestic Water Valve
- EXIT Evacuation Route
- Furniture/ Equip.
(turnover/ equipment/ removable partitions)
- Permanent Partition
(non-removable permanent partitions)
- Fire Barrier
(fire rated enclosures that are fire stopped,
ex: permanent partition walls of demising
corridors, & mech. equip. rooms)
- In-Building Relocation Areas (IBRAs)
- Non-Sprinkled Areas
*Shown on partially covered floors

NO.	DATE	NAME	ISSUED BY COMMENTS
1	07.05.22	CP/JAW	RE-AGED PER ANNUAL SURVEY 06.21.22 ISSUED FOR REVIEW
1	07.27.22	JAW	RE-AGED PER COMMENTS ISSUED FOR REVIEW

Drawn By: MD Checked By: XK

BUILDING ADDRESS:
1385 Broadway
 New York, N.Y. 10018

DRAWING TITLE:
FL-19
 19th Floor

SURVEY BY: VM SURVEY DATE(S): 06.09.21

West 38th Street

FULL SPRINKLER COVERAGE