

520 MADISON “PLUG + PLAY” SUBLEASE





ENTIRE 26TH FLOOR

23,411 RSF

POSSESSION

February 2025

TERM

May 2026

COMMENTS

- Short term plug and play space
- Entire floor presence
- Efficient, column free floor
- Premier building, location and natural light
- Walking distance from Grand Central Terminal
- Furniture is available

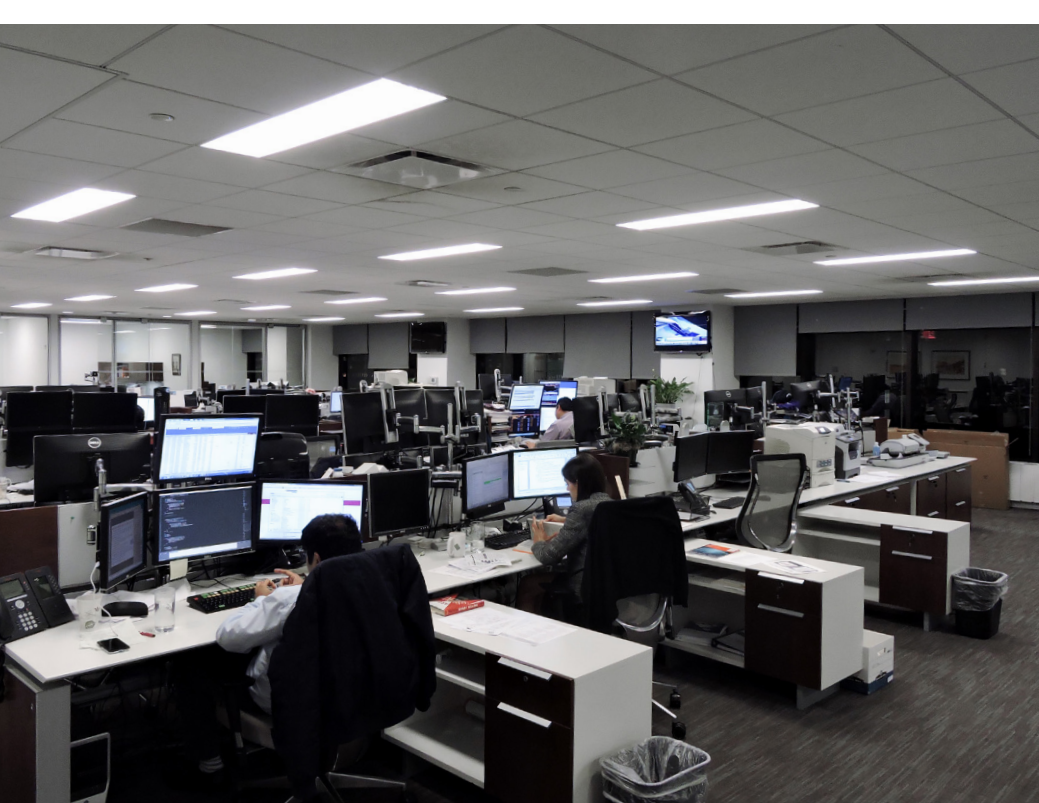

520 MADISON

54th Street

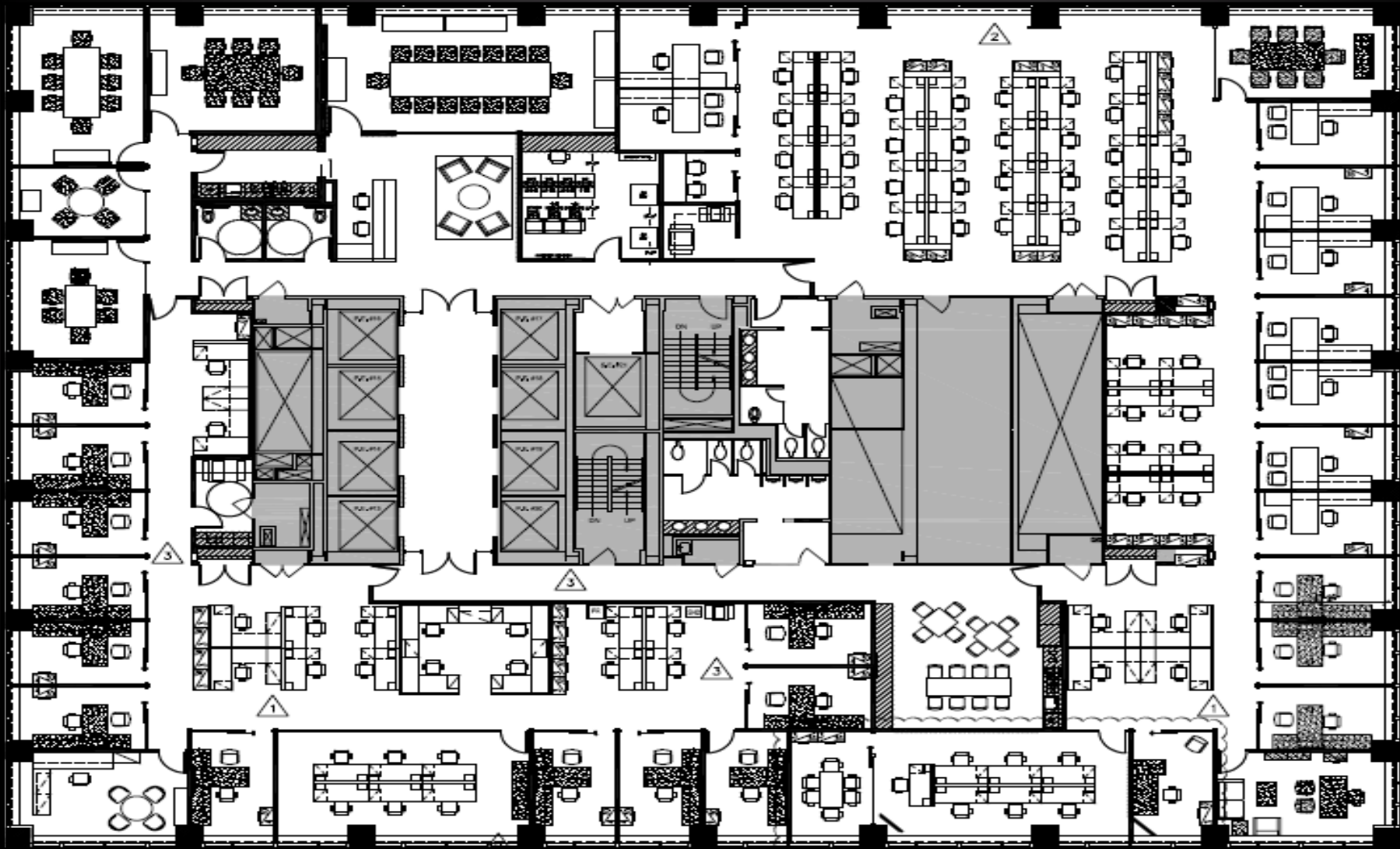

Madison Avenue

53rd Street