



# 520 Madison

**Entire 41<sup>ST</sup> Floor** 23,411 RSF

Possession: Immediate  
Term: Through 05/30/2031





- Built space
- Central Park views with terrific light in all directions
- Column free floor plates
- Financially strong sublandlord

**520 Madison Avenue** offers breathtaking views of the neighborhood and the **New York City skyline** from its high floors. Tenants and visitors can enjoy views of **Central Park** and **Manhattan**.





**ENTIRE 41<sup>ST</sup> FLOOR**





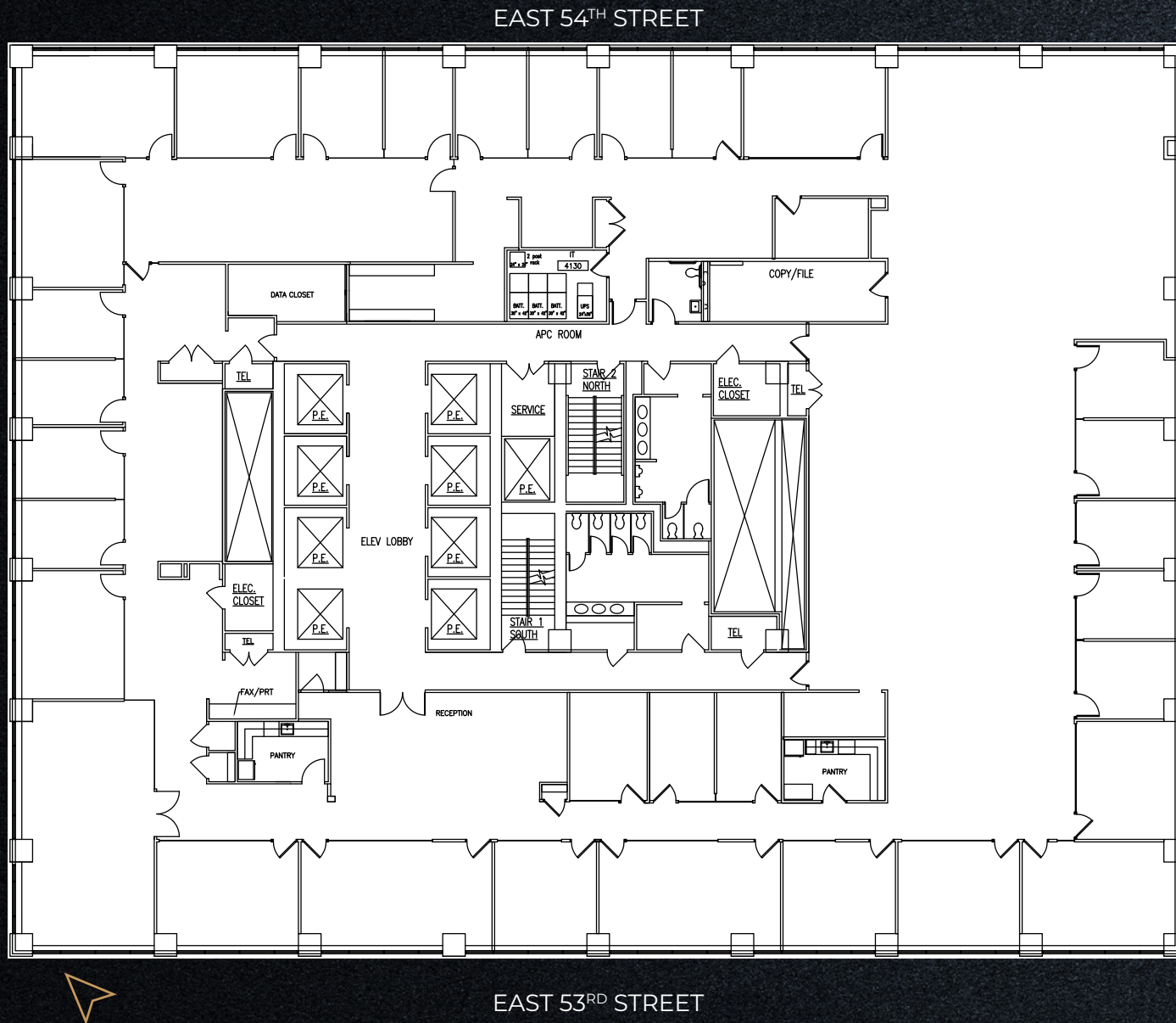

## ENTIRE 41<sup>ST</sup> FLOOR

EXISTING  
CONDITION

Total Offices	28
Workstations	72
Conference Rooms	4
Receptionist	1
Total Personnel	81