



# **485 LEXINGTON AVENUE**

NEW YORK, NY



# FOR SUBLEASE

ENTIRE 16TH FLOOR  
**28,116 RSF**

OR

PARTIAL 16TH FLOOR  
**12,828 RSF**

Located steps away from the newly created north entrance to Grand Central Terminal with unparalleled access to a vast array of subway, bus, and train lines. 485 Lexington Avenue features an abundance of amenities, including extended HVAC hours and a 100-car on-site parking garage.



**AVAILABLE:**  
Arranged



**TERM:**  
Through July 30, 2033







## PROPERTY FEATURES

- Steps from grand central terminal
- On-site parking garage and bike room

## SPACE FEATURES

- Newly built space completed October 2020
- Sublandlord will deliver entire floor or divide to 12,828 RSF
- Polished concrete floors and exposed ceilings
- Large usable terrace
- Financially stable sublandlord



WiredScore  
PLATINUM

PARTIAL  
16TH FLOOR  
12,828 RSF

LEXINGTON AVENUE

EAST 47TH STREET



EAST 46TH STREET

EAST 47TH STREET

ENTIRE  
16TH FLOOR  
28,116 RSF

LEXINGTON AVENUE

EAST 46TH STREET

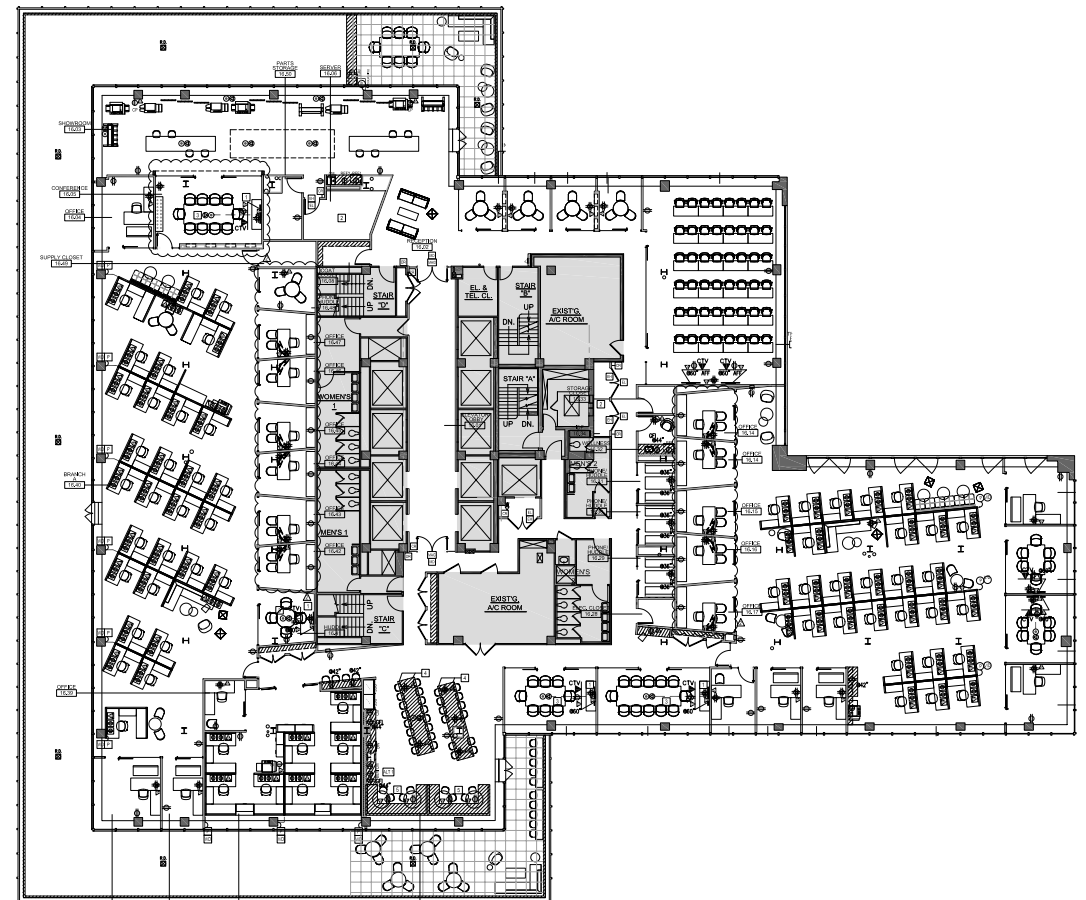





## TRANSPORTATION

- 51 Street Transit Stop (4 6) - 4-minute walk
- Grand Central-42 Street Transit Stop (42 St Shuttle, 4 5 6 7) - 5-minute walk
- Lexington Avenue-53 Street Transit Stop (E M) - 6-minute walk
- 5 Avenue-Bryant Park Transit Stop (7) - 10-minute walk
- Grand Central Terminal Commuter Rail (Hudson, Harlem, New Haven Lines) - 5-minute walk



