

# 485 LEXINGTON AVENUE

NEW YORK, NY

## FOR SUBLEASE

ENTIRE 16<sup>TH</sup> FLOOR

28,116 RSF



**AVAILABLE**  
Immediate



**TERM**  
Through  
July 30, 2033



28,116 RSF

EAST 47TH STREET

LEXINGTON AVENUE

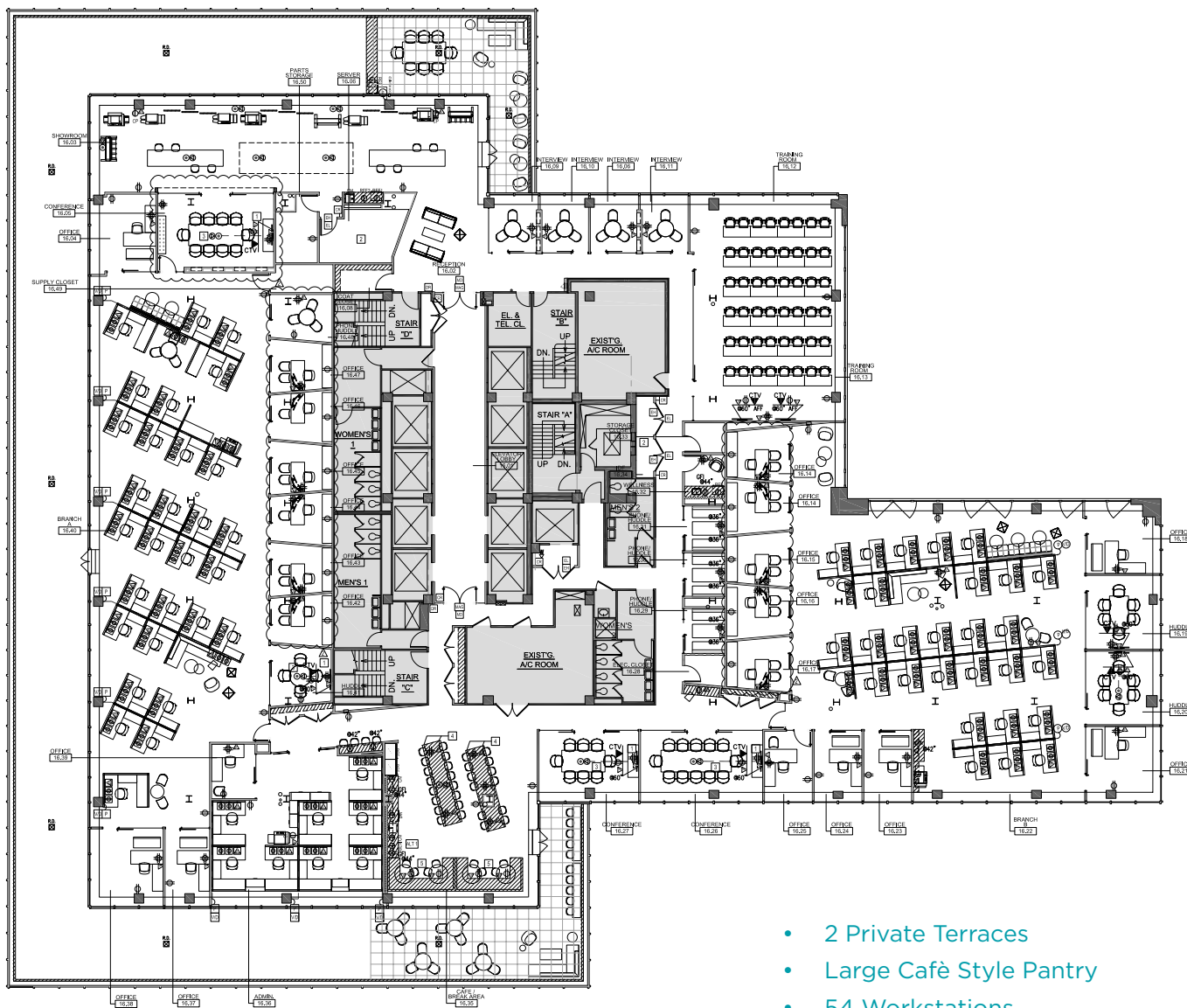

EAST 46TH STREET

[VIEW TERRACE VIDEO](#)[VIEW PANTRY VIDEO](#)

- 2 Private Terraces
- Large Café Style Pantry
- 54 Workstations
- 48 Seat Training Room
- 7 Windowed Offices
- 14 Interior Offices
- 1 Twelve Person Conference Room
- 1 Ten Person Conference Room
- 1 Eight Person Conference Room
- 2 Six Person Meeting Rooms
- 1 Four Person Meeting Room
- 5 Three Person Meeting Rooms



# 16<sup>TH</sup> FLOOR

485 LEXINGTON AVE

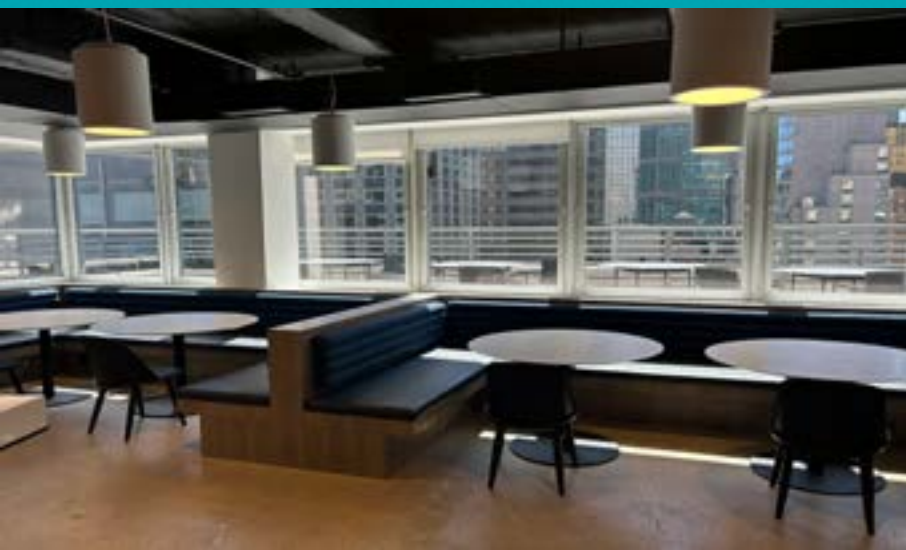



485 LEXINGTON AVE



Located steps away from the newly created north entrance to Grand Central Terminal with unparalleled access to a vast array of subway, bus, and train lines.

485 Lexington Avenue features an abundance of amenities, including extended HVAC hours and a 100-car on-site parking garage.

## PROPERTY FEATURES

- Steps from grand central terminal
- On-site parking garage and bike room

## SPACE FEATURES

- Newly built space completed October 2020
- Polished concrete floors and exposed ceilings
- Large usable terraces (Fully furnished and wired)
- Financially stable sublandlord

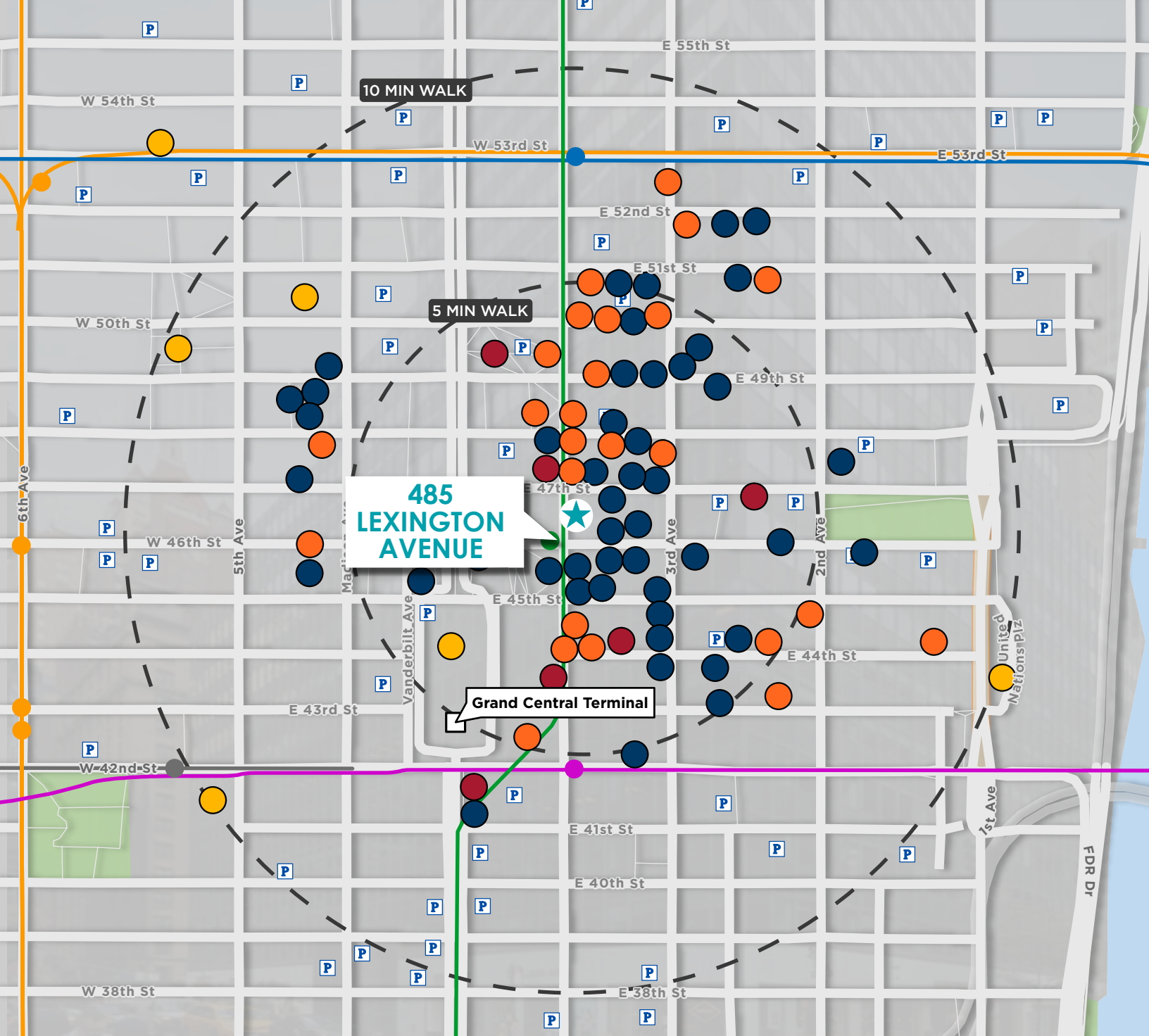

**40+**  
RESTAURANTS

**25+**  
HOTELS

**5+**  
POI

**5+**  
HEALTH CLUBS / GYMS

## TRANSPORTATION

- 51 Street Transit Stop (4 6) - 4-minute walk
- Grand Central-42 Street Transit Stop (42 St Shuttle, 4 5 6 7) - 5-minute walk
- Lexington Avenue-53 Street Transit Stop (E M) - 6-minute walk
- 5 Avenue-Bryant Park Transit Stop (7) - 10-minute walk
- Grand Central Terminal Commuter Rail (Hudson, Harlem, New Haven Lines) - 5-minute walk