

29 West 14th Street

Between 5th & 6th Ave | Union Square



29 West 14th Street

Between 5th & 6th Ave | Union Square

SIZE: 3,100 SF Ground Floor

FRONTAGE: 20'

CEILING HEIGHTS: 15 ft

ASKING RENT: Upon Request

POSSESSION: Immediate

TRANSPORTATION:



HIGHLIGHTS:

- Move-in ready
- Delivered “as-is” with existing furniture in place
- Space includes 2 ADA restrooms, small conference room, & kitchenette
- Close proximity to Union Square, Chelsea, & West Village
- Neighboring tenants include: *Popeye's, Baskin Robbins, CVS, The New School, Taco Bell, Joe Coffee, Chase, Pressed Juicery, Pinkberry, GNC, McDonald's, Chipotle, Think Coffee, Pratt*

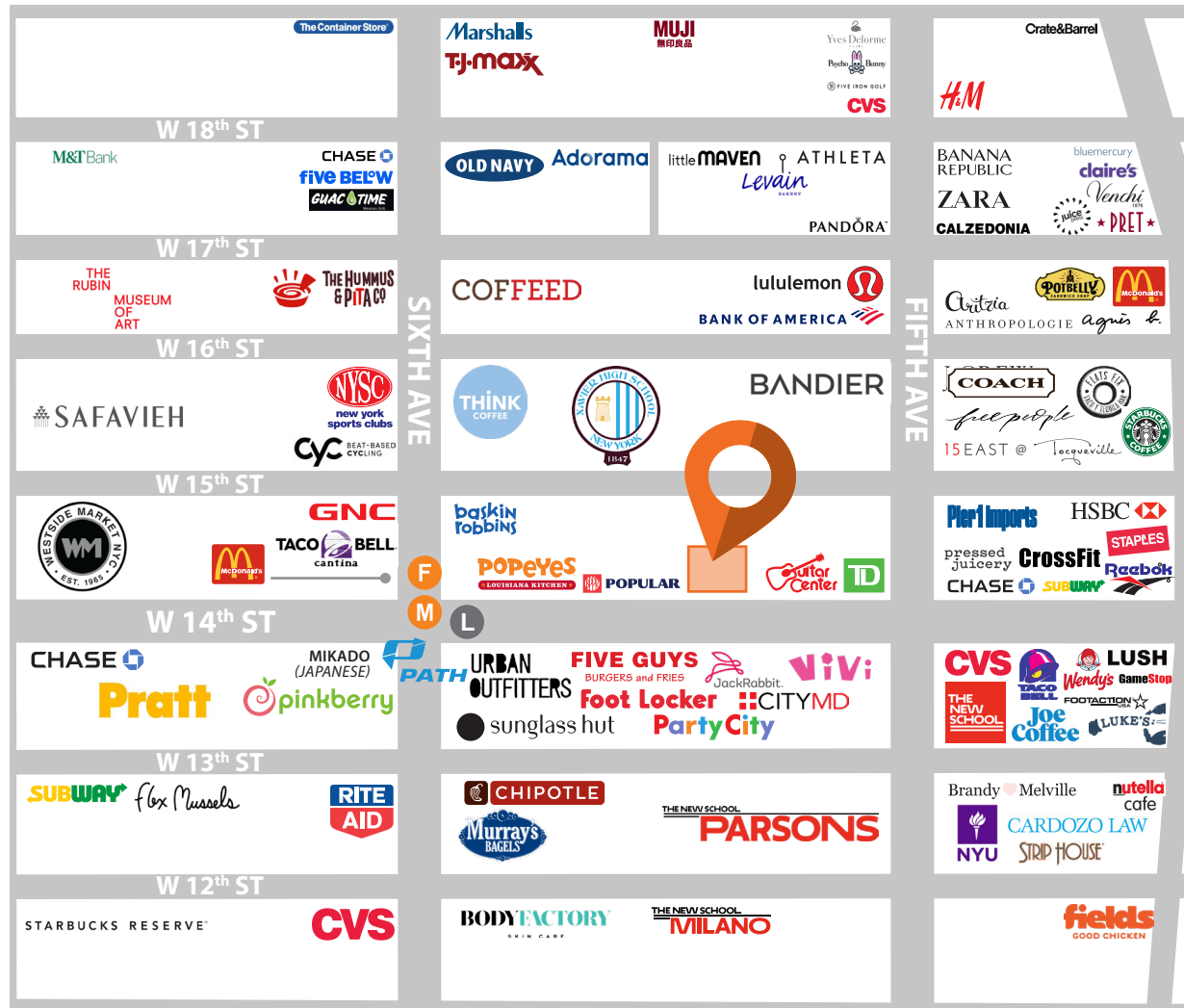

29 West 14th Street

Between 5th & 6th Ave | Union Square

Floor Plans:
Ground Floor - 3,100 SF

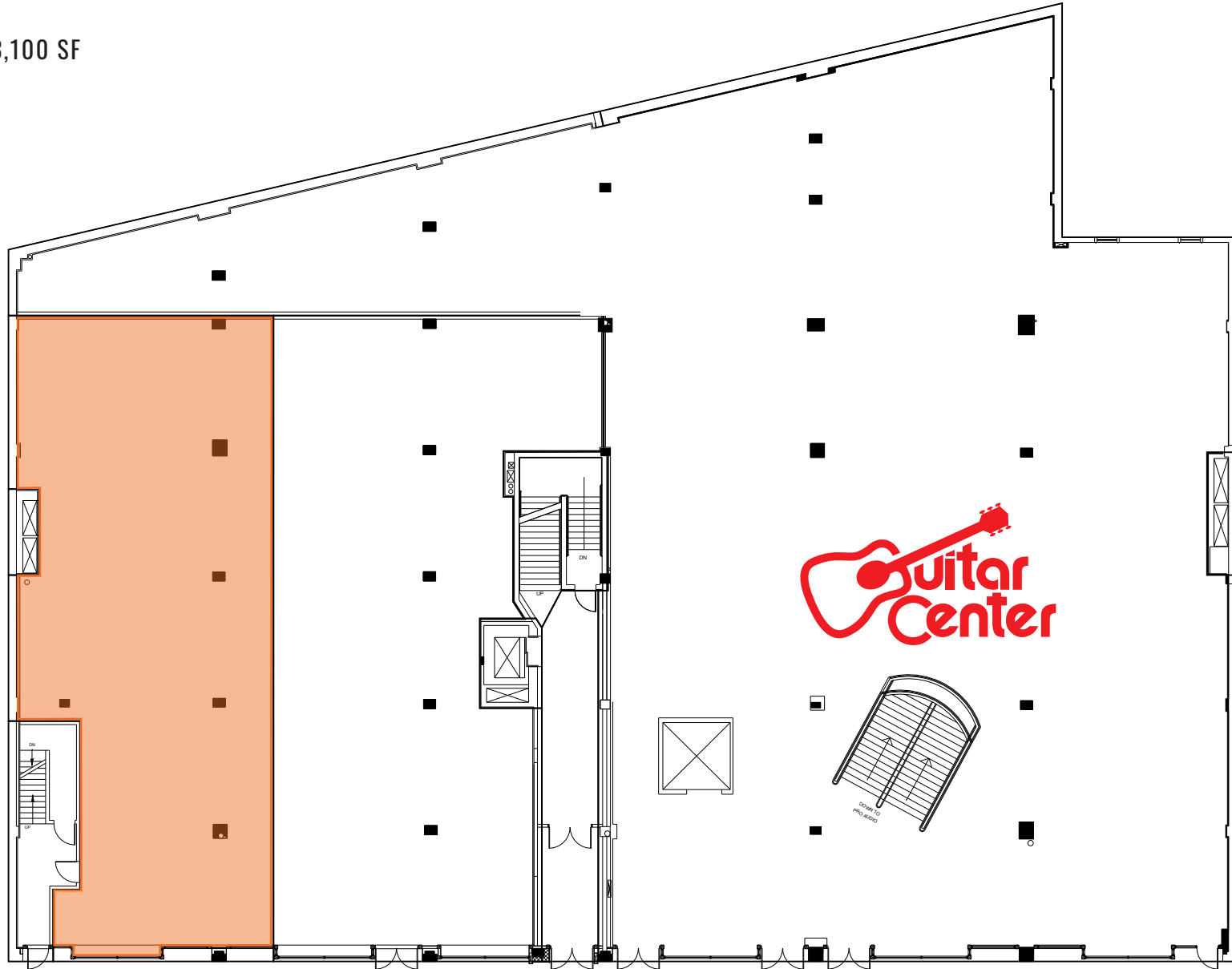

29 West 14th Street

Between 5th & 6th Ave | Union Square

Interiors:

