

ONE GRAND CENTRAL PLACE

— 60 EAST 42ND STREET —

SUITE 1320 | 5,772 SQ.FT.

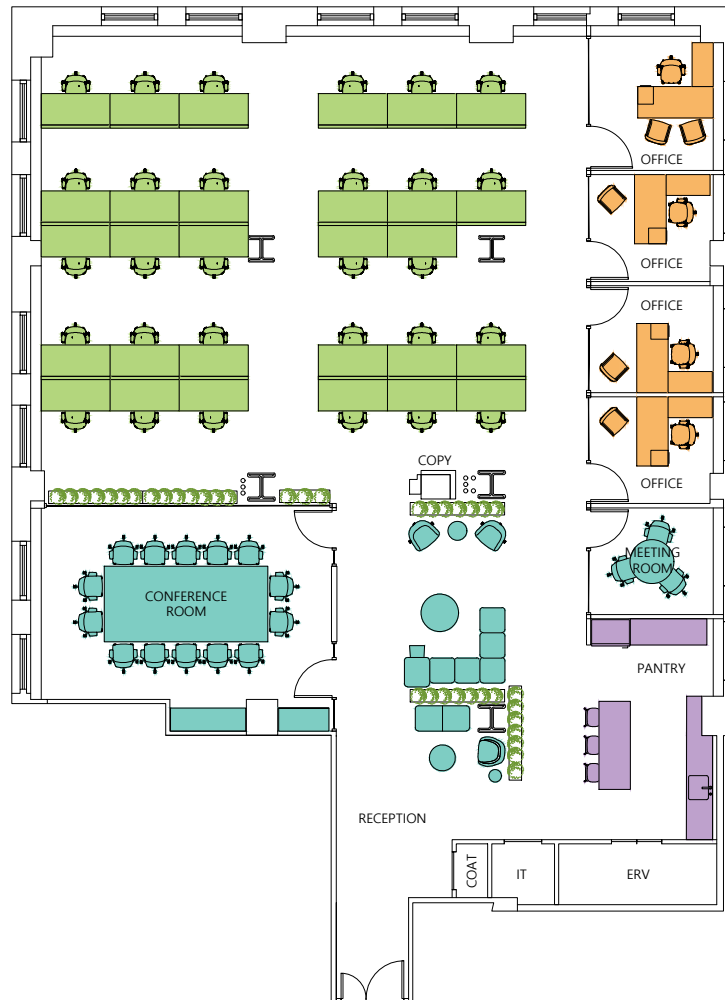

Category	Qty
Office	4
Workstation (5'-6" Bench)	29
TOTAL	33
Reception	1
Conference Room	1
Meeting Room	1
Pantry	1
IT	1
Copy	1
Coat	1
Future	

