

BOUTIQUE MEDICAL / OFFICE / FLEX

Plaza District / Upper East Side - Office Suites 30 East 60th Street (bet. Madison & Park)



MODERN, ATTENDED LOBBY
4 PASSENGER ELEVATORS + FREIGHT
24/7 ACCESS
HIGH-SPEED INTERNET
PRIVATE RESTROOMS IN EVERY SUITE

BUILT MEDICAL, DENTAL & OFFICE
NEW CONSTRUCTION VANILLA BOXES
TENANT-CONTROLLED HVACs
FULL SERVICE RENT
CONCESSIONS, TI and LANDLORD WORK

PRIME LOCATION

Steps from Central Park, Fifth Ave & Madison Ave Shopping
MULTIPLE SUBWAY ACCESS: 4, 5, 6, F, N, Q, R, W

800 – 1200 RSF small office and medical
4th floor fully plumbed dental office
Several **1300-1600 RSF** medical spaces

1750 RSF built office
2360 to 2720 RSF suites on floors, 10, 12 & 22
Vanilla box and shell spaces (new tower)

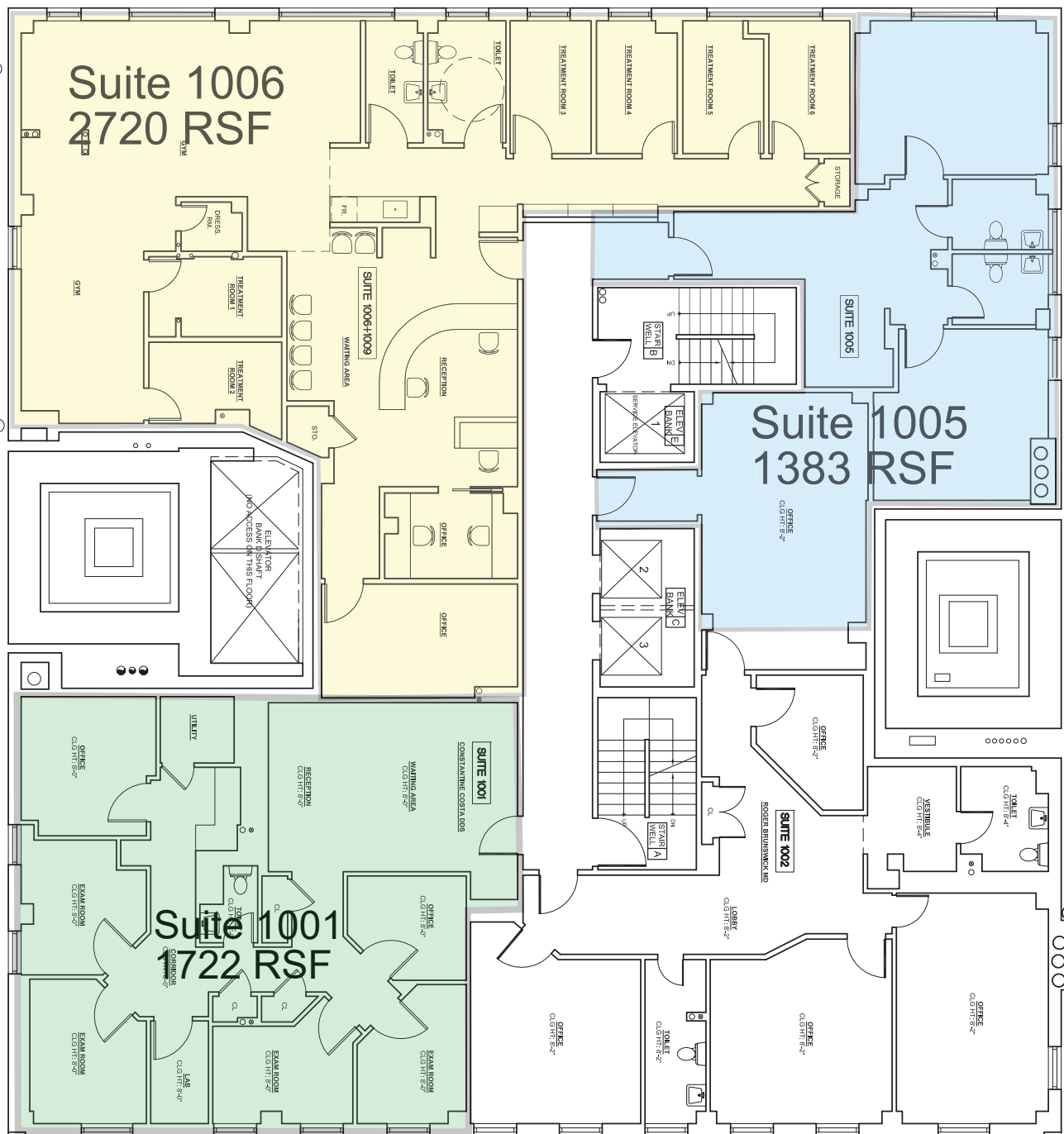

10TH FLOOR PLAN
SCALE: 1/8"=1'-0"

