

22WEST21

Furnished Flatiron Prebuilt 6,240 RSF AVAILABLE

Direct Space



- Possession November 1st, 2025 (Potential for Earlier Date)
- 7th Floor
- Sit-Stand Desks
- Fully Furnished Pre-built
- Open Area for 45+
- Lobby Attendant

Attended Lobby

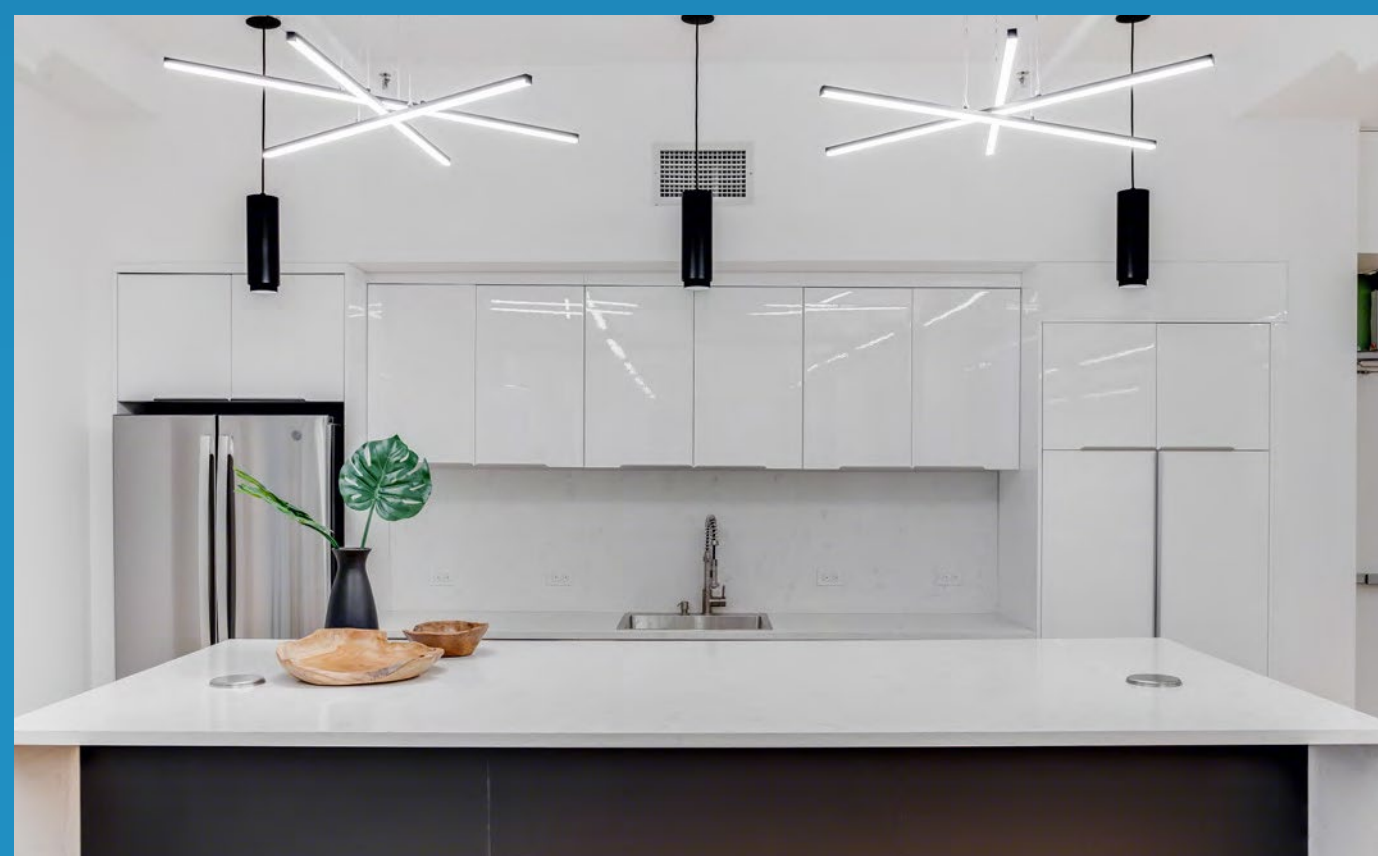
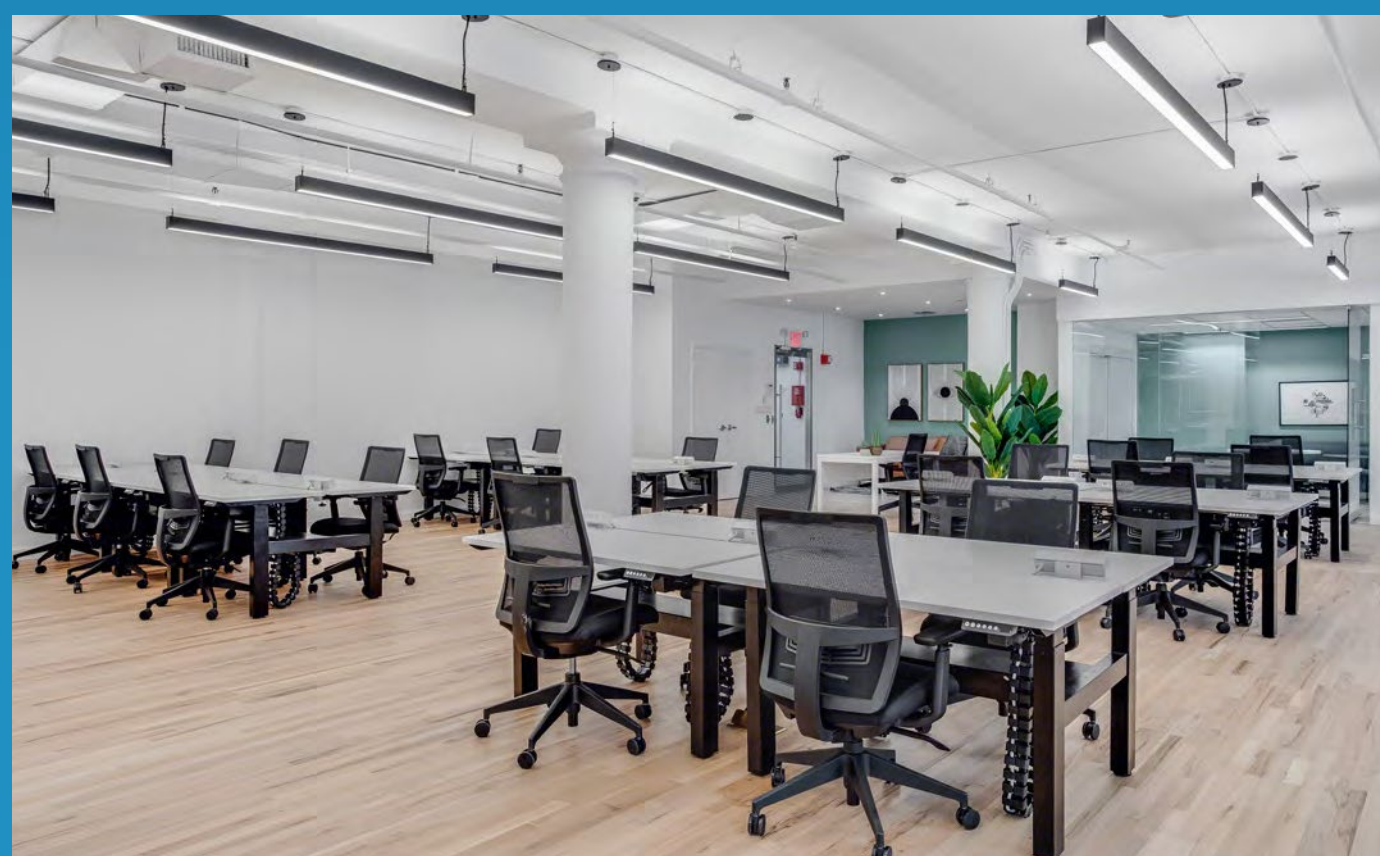

Welcome to the Flatiron District



Partial Floor of 6,240 RSF Available

Landlord Will modify as needed

SUITE 701

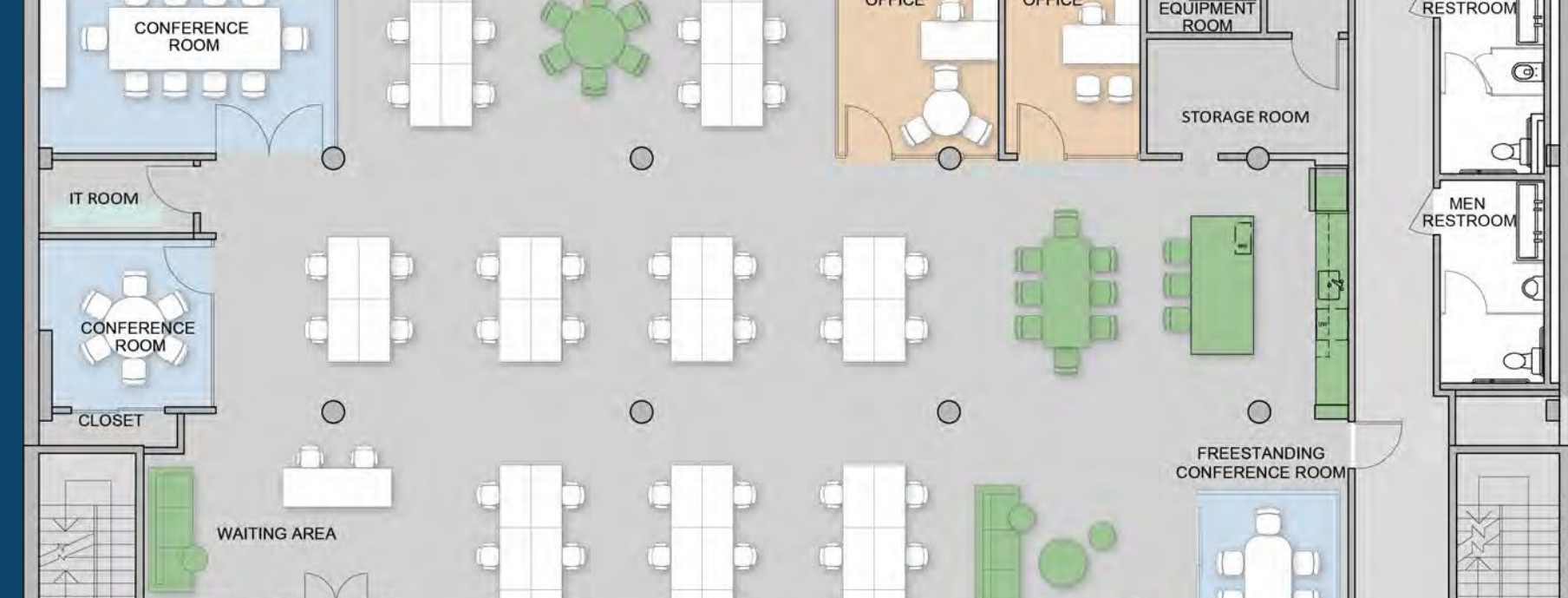

- Sit-Stand Desks 46
- Conference Rooms 3
- Executive Offices 2
- Lounge Areas 2
- Pantry 1

