

# 767 FIFTH AVENUE

Sublease  
Partial 16th Floor

11,440 RSF (BUILT) +  
7,657 RSF (RAW) =  
19,097 RSF Total

CAN BE SUBLEASED  
TOGETHER OR  
SEPARATELY

*Actual View*



# 11,440 (BUILT) + 7,657 (RAW) = 19,097 RSF Total

Possession: Immediate  
Term: April 2033

- Contiguous units but could be subleased **individually** or **together**
- Built portion was constructed 2 years ago to high-custom-design-standard
- Central Park views
- Concessions available for the raw portion
- Building includes new tenant-only amenity center with gym, conferencing, lounge and food & beverage offerings

Executive Office	1	Meeting/Wellness	1
Office	1	Workstations	38
Shared Office	3	Pantry	1
Conference	3	Copy/Print	1
Meeting	1	Reception	1

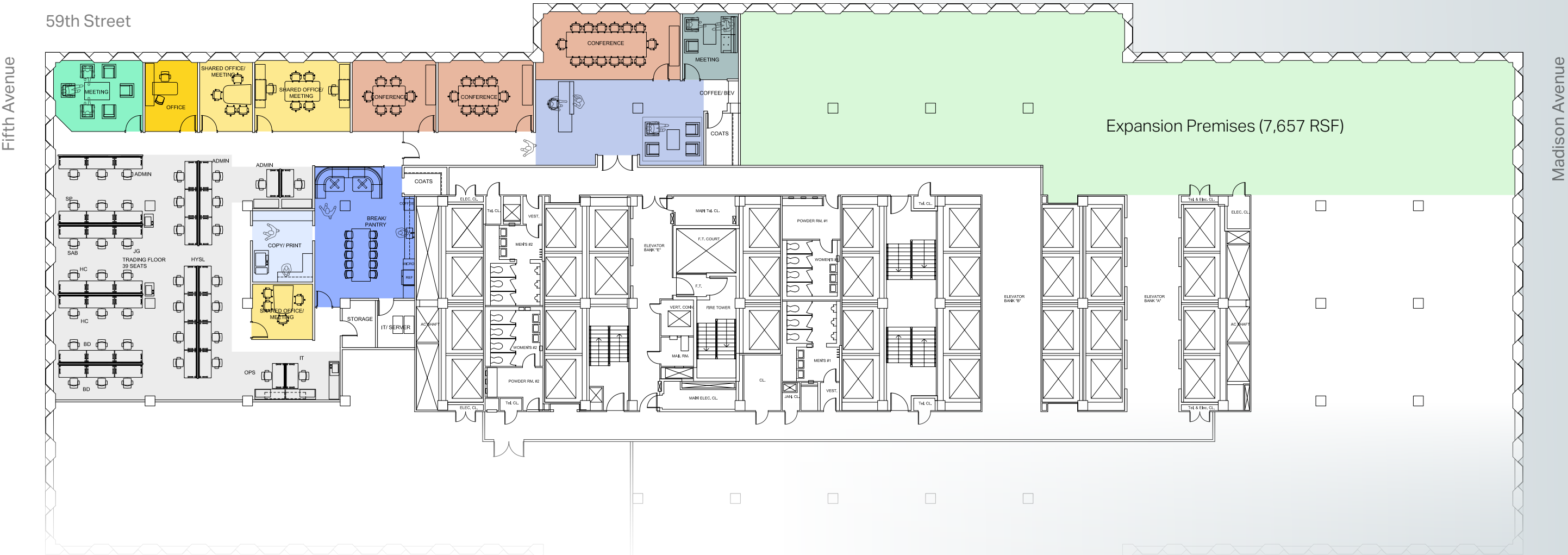



MEETING ►



▲ RECEPTION ►







◀ SHARED OFFICE



▲ CONFERENCE



◀ WORKSTATIONS





EXECUTIVE OFFICE ▲

PANTRY ►



ELEVATOR BANK ►





## The Savoy Club



Savoy Club is a 35,000 SF amenity experience offering clients access to a best-in-class fitness and health center, an innovative food & beverage concept, and a fully appointed conferencing suite.



# The Savoy Club

CONFERENCE CENTER ►



FOOD & BEVERAGE ▲

FITNESS & HEALTH CENTER ►



In keeping with the building’s legendary marble façade, the Club was designed around grand architectural gestures and outfitted with a warm, enveloping palette of marble, plaster, and white oak millwork.