

# 137 West 25th Street

## Office Condo for Sale

Between Sixth & Seventh Avenues



### Chelsea

**SIZE: 7,690 sf.**

**FLOOR: Fifth**

**PRICE: \$4,550,000**

**POSSESSION: Immediate**

**COMMON CHARGE: \$5.90 PSF.**

**TAXES: \$10.09 PSF.**

**MAJOR PRICE REDUCTION - BEST VALUE IN MARKET**  
*Full Floor Office Condo for Sale in Manhattan*

The perfect mix of modern glass architecture combined with the natural ambience of wood floors, high loft ceilings and original brick accents make this office loft very special!

Perfect flexible layout for law, accounting, tech firms, architecture, design companies. Excellent new like condition.

#### Space Features:

- (5) Large Executive Offices or Team Rooms plus an add'l (10) offices for a total of (15) private offices.
- (1) Large open area (seats 16 - 24 workstations)
- (1) Conference Room (glass partitioned all 4-sides)
- (1) Windowed Conference Room
- Raw Steel Finished Elevator Doors
- Custom Reception Desk (reclaimed wood), accented with aluminum, framed by original brick columns
- Spacious Pantry w/ Dishwasher, Stainless Steel Refrigerator, Modern Cabinetry, Bar Seating (Eat-In)
- (4) Private Restrooms
- Wide Column Spacing accommodates all uses

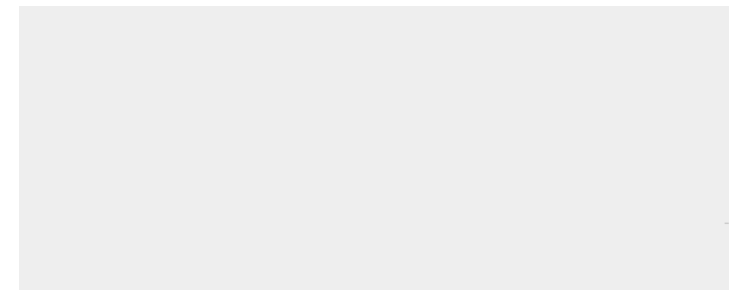



# 137 West 25th Street

Office Condo for Sale

*Between Sixth & Seventh Avenues*





# Office Condo for Sale

# 137 West 25th Street

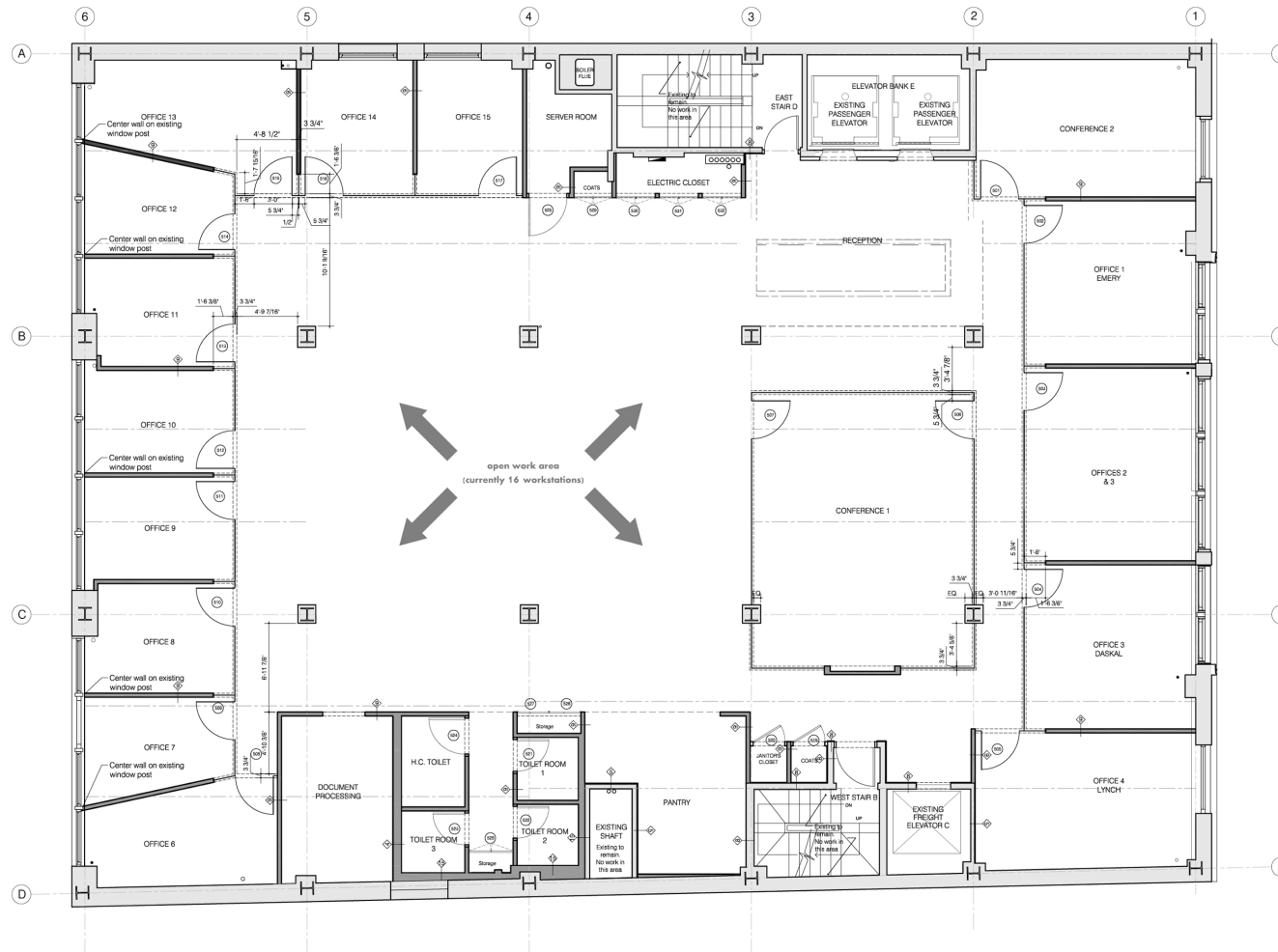

# 137 West 25th Street

Office Condo for Sale

*Between Sixth & Seventh Avenues*

