

PENN 1

Breathtaking views of South and West, and direct access to Penn Station and Moynihan Train Hall.



PARTIAL 47TH FLOOR

10,873 RSF

SUBLEASE TERM: THROUGH
11/2028

POSSESSION: IMMEDIATE

NOTES

- Immaculate Premises
- Built with perimeter offices and open area
- 12 offices (8 perimeter and 4 interior)
- Unobstructed views for miles south to 1 WTC and Statue of Liberty and west to Hudson Yards
- Great light
- Corner unit
- Double glass door entrance
- Mint condition
- Superior credit sublessor





CONFERENCE ROOM



OPEN AREA



Located in the heart of New York City, PENN 1's accessibility reaches far beyond Manhattan. Sitting at the midpoint of what is quickly becoming one of the world's most vibrant tech corridors, Manhattan's far west side has attracted major technology firms like Amazon, Apple and Facebook.

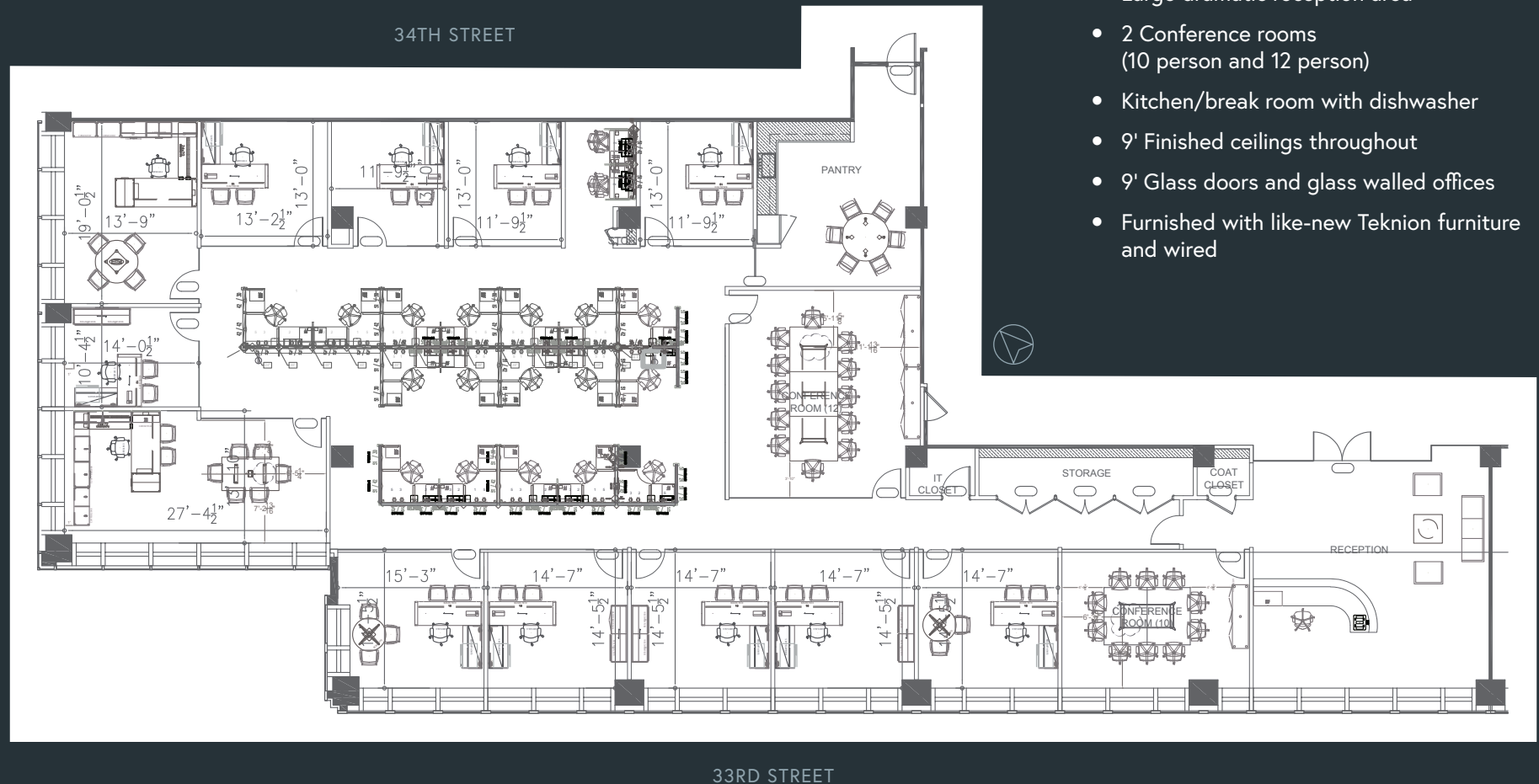

COUNTS

- 12 Offices (8 perimeter and 4 interior)
- 19 Workstations
- Large dramatic reception area
- 2 Conference rooms (10 person and 12 person)
- Kitchen/break room with dishwasher
- 9' Finished ceilings throughout
- 9' Glass doors and glass walled offices
- Furnished with like-new Teknion furniture and wired



PENN 1