

# INCREDIBLE VALUE / SHORT-TERM SUBLEASE PROXIMATE TO GRAND CENTRAL



## Space Profile

Floor: **Entire 4th – 29,935 RSF**

**Partial 5th – 15,427 RSF**

**Total: 45,362 RSF**

**Floors can be leased together or separately**

Asking Rent: **Upon Request**

Possession: **May 2024**

Term: **Through March 31, 2026**

## Key Highlights

- Strong Sublandlord and Landlord
- Built and furnished installation featuring a mix of offices and open areas
- Proximate to Grand Central Terminal

## Partial 5th Floor

15,427 RSF

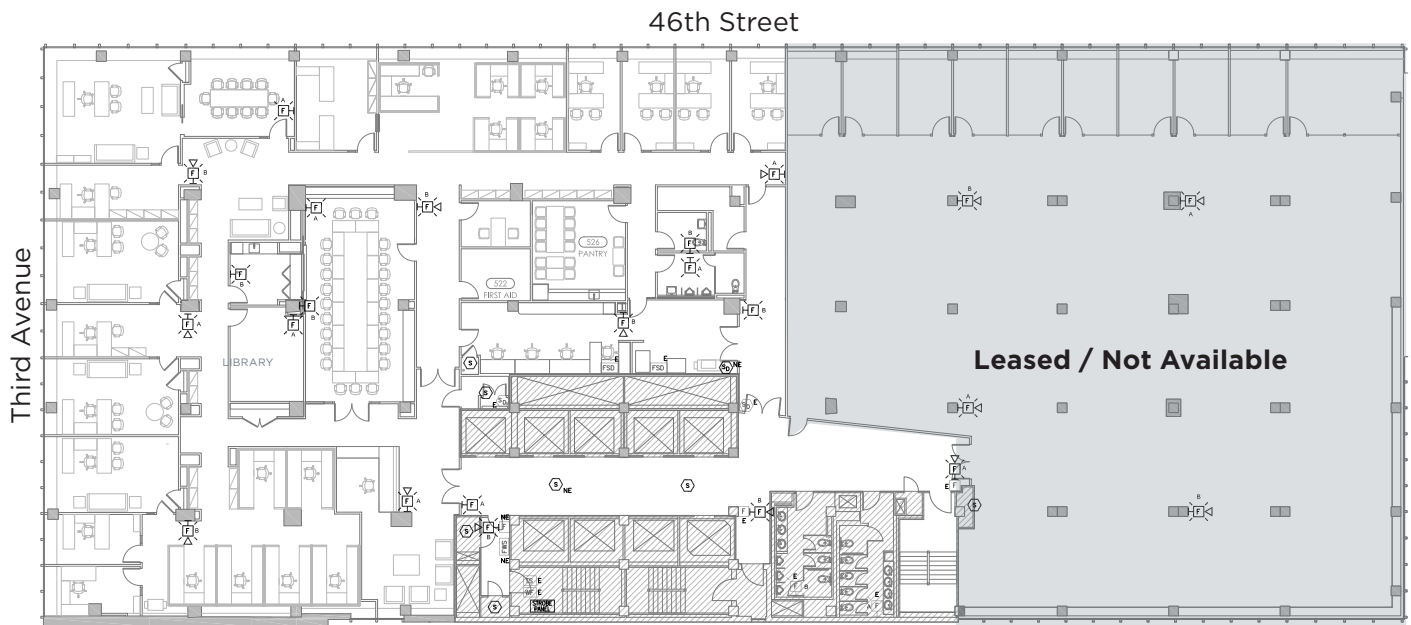

## Space Overview

- 11** perimeter offices
- 11** workstations
  - 1** conference room for 24 people
  - 1** conference room for 10 people
  - 1** pantry

5th Floor

