



# 10 FIFTH AVENUE

# Entire 8th Floor

**SIZE** 16,282 RSF **AVAILABILITY** Immediate

# Entire 7th Floor

**SIZE** 16,282 RSF **AVAILABILITY** 10/1/2024

## COMMENTS

- Prebuilt designed by TPG will be constructed on the 8th floor
- Landlord can provide a new turnkey installation or renovate the existing installation on behalf of a new tenant
- One block from Union Square
- Exceptional natural light, oversized windows, above-standard ceilings
- Efficient side core floorplate with versatility

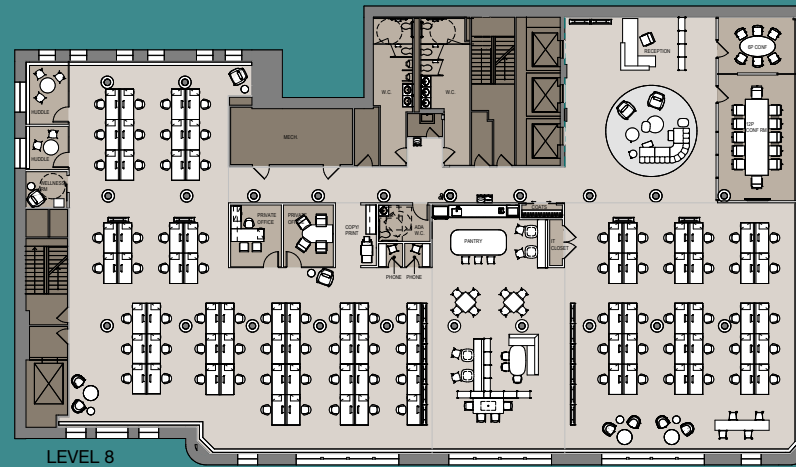

## 8TH FLOOR PREBUILT

WORKSTATIONS: 82  
PRIVATE OFFICES: 1  
CONF ROOMS: 5  
RSF/ Seat: 196 SQ FT

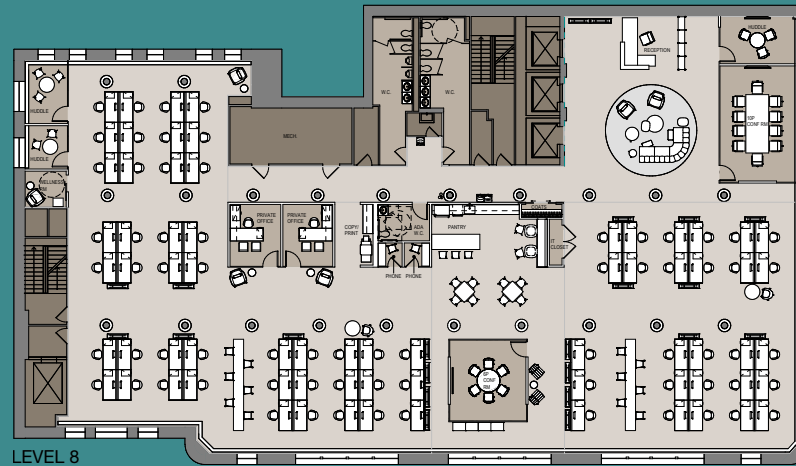

## OPEN LAYOUT TEST FIT

WORKSTATIONS: 70  
PRIVATE OFFICES: 2-3  
CONF ROOMS: 1  
RSF/ Seat: 223 SQ FT

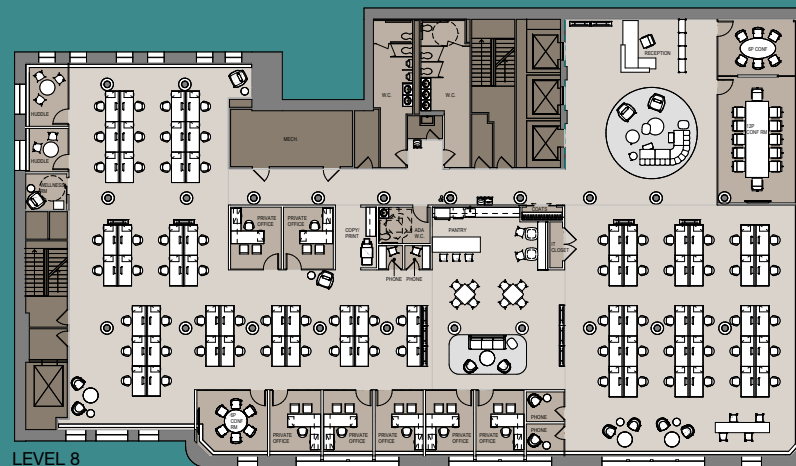

## HYBRID LAYOUT TEST FIT

WORKSTATIONS: 70  
PRIVATE OFFICES: 7  
CONF ROOMS: 3  
RSF/ Seat: 211 SQ FT

