



PARK AVENUE TOWER

AT 65 E 55TH ST

SUBLEASE
OPPORTUNITY

ENTIRE 9TH FLOOR:
17,878 RSF

THE CLUB

Exclusive Amenity Center



Conference center



Fitness center with locker rooms/executive laundry and wellness programming



Curated grab-and-go food service



Recreation Lounge

ENTIRE 9TH FLOOR 17,878 RSF

Term
JUNE 29, 2029

Possession
IMMEDIATE

Asking Rent
UPON REQUEST



- Existing high-end installation, move in condition
- Furniture and technology can be made available
- Supplemental HVAC in place
- Efficient, full floor opportunity and layout
- Exclusive Building Amenity Center; conference rooms, fitness, lounge and café
- Prime Plaza District location

ENTIRE 9TH FLOOR 17,878 RSF



FLOOR PLANS

Entire 9th Floor: 17,878 RSF

EXISTING INSTALLATION

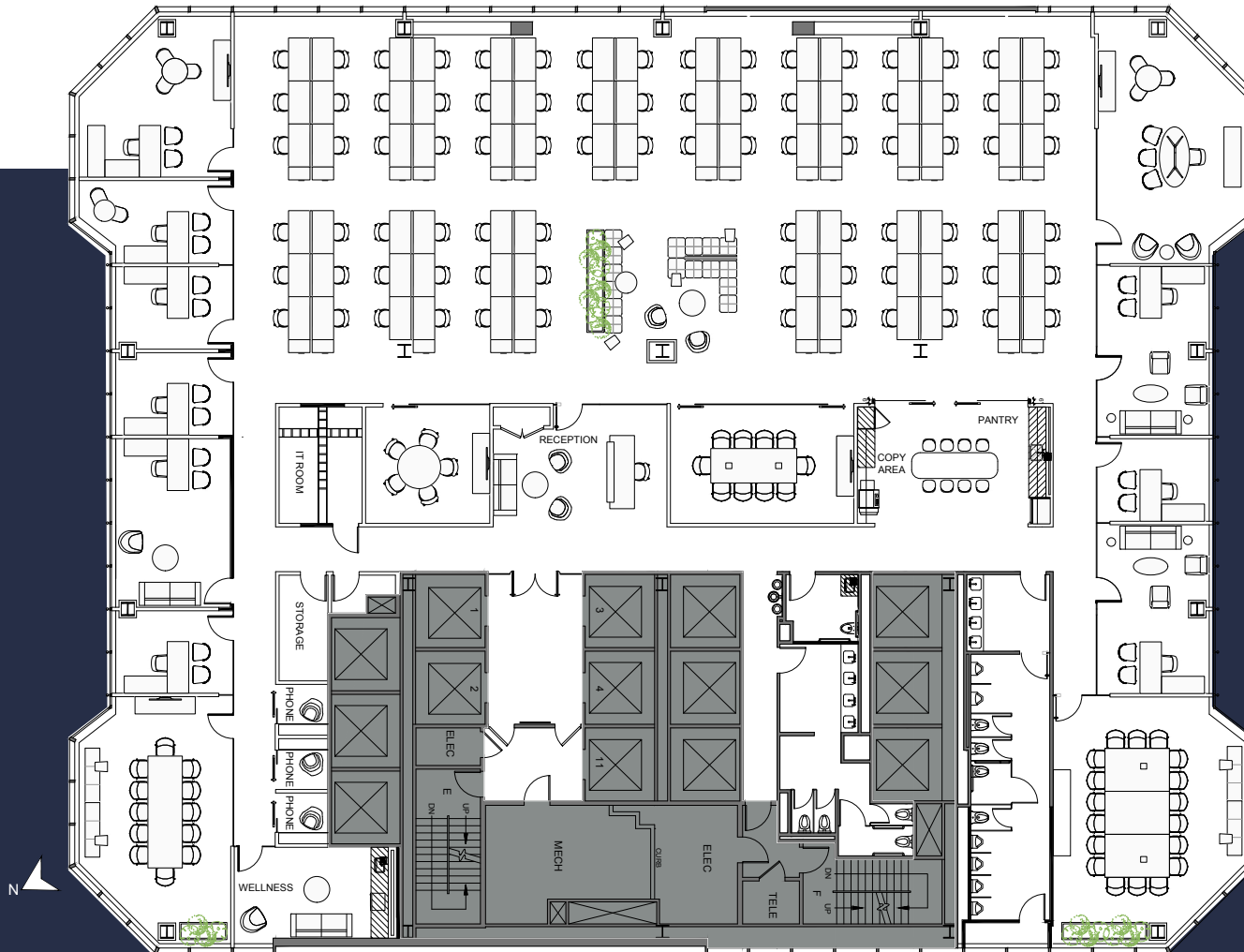

An aerial night photograph of the Park Avenue Tower in New York City. The building is the central focus, illuminated from within, showing a grid of lit windows. It has a distinctive pyramidal top. Surrounding it are other skyscrapers, some also lit, and others in shadow. The sky is a deep twilight blue.

PARK AVENUE TOWER

AT 65 E 55TH ST