

PARK AVENUE PERFECTION

Park Avenue Tower



Space Profile

Size: **19,111 SF**

Floor(s): **Entire 7th**

Rate: **Upon request**

Availability: **Immediate**

Term: **Through 11/2035 (shorter term possible)**

Key Highlights

- Full-floor newly-built modern financial services installation with exposed ceilings and primarily open space
- Institutional Sublandlord and Landlord
- Class "A" building with newly-installed amenities including: fitness center, meeting facilities, coffee bar, pool room and lounge space

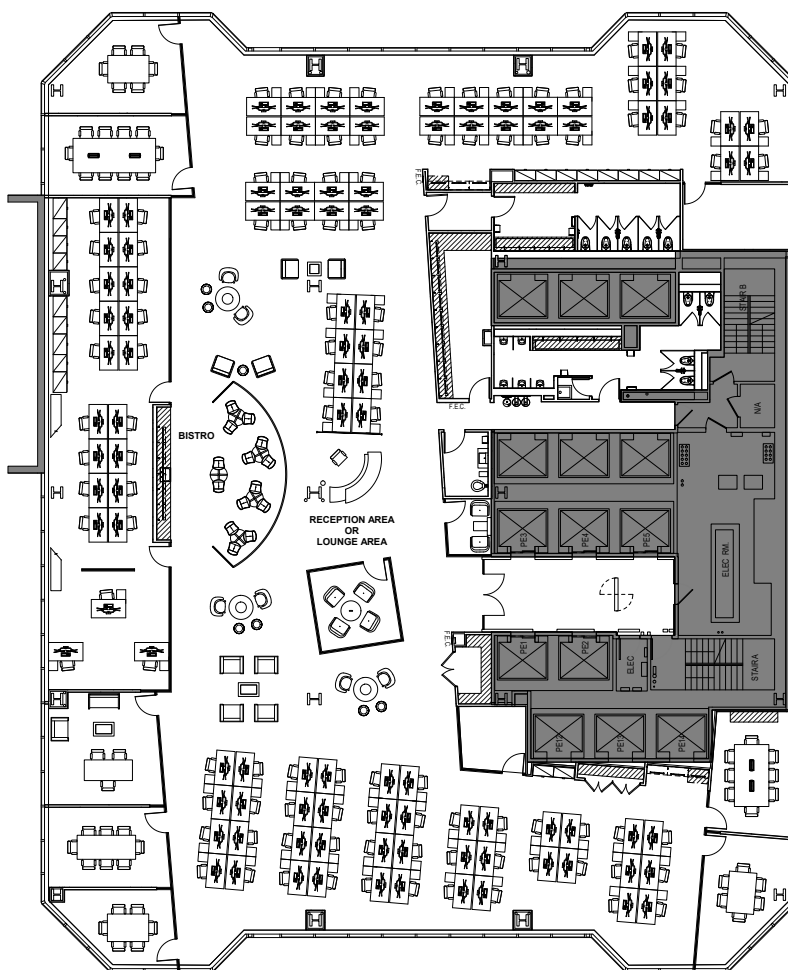

Space Overview

- 86** bullpen positions
- 18** trading positions in a separated trading room
- 8** meeting / conference rooms of varying sizes
- 1** pantry / seating area

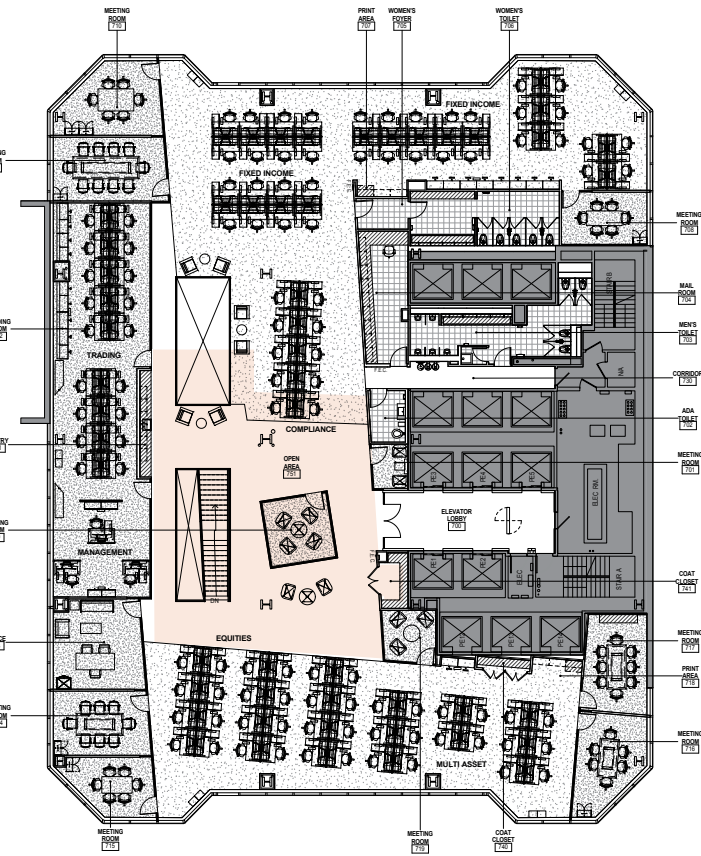

Sublandlord's Proposed Work

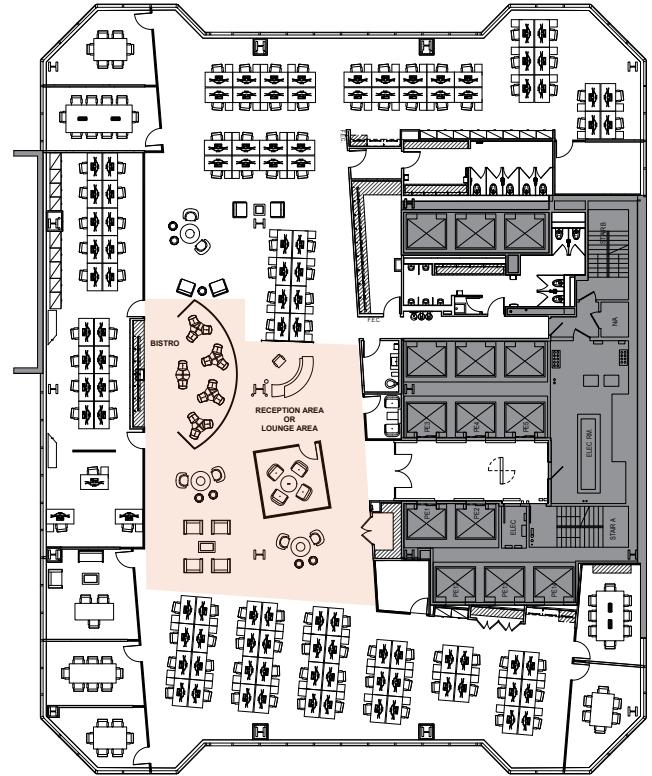

SUBLEASE 65 East 55th Street, New York, NY 10022 | Between Park & Madison Avenues



