



# 275 Madison Ave

Partial 21<sup>st</sup> Floor | 2,627 RSF

Possession | Immediate    Term | July 2028    Type | Sublease





## Space Highlights

- Private outdoor terrace overlooking Bryant Park
- Steps from Grand Central
- Great natural light and exposure
  - Multiple sides of windows
- Lobby attended 24/7

# Floorplan

## Partial 21st Floor

2,627 SF

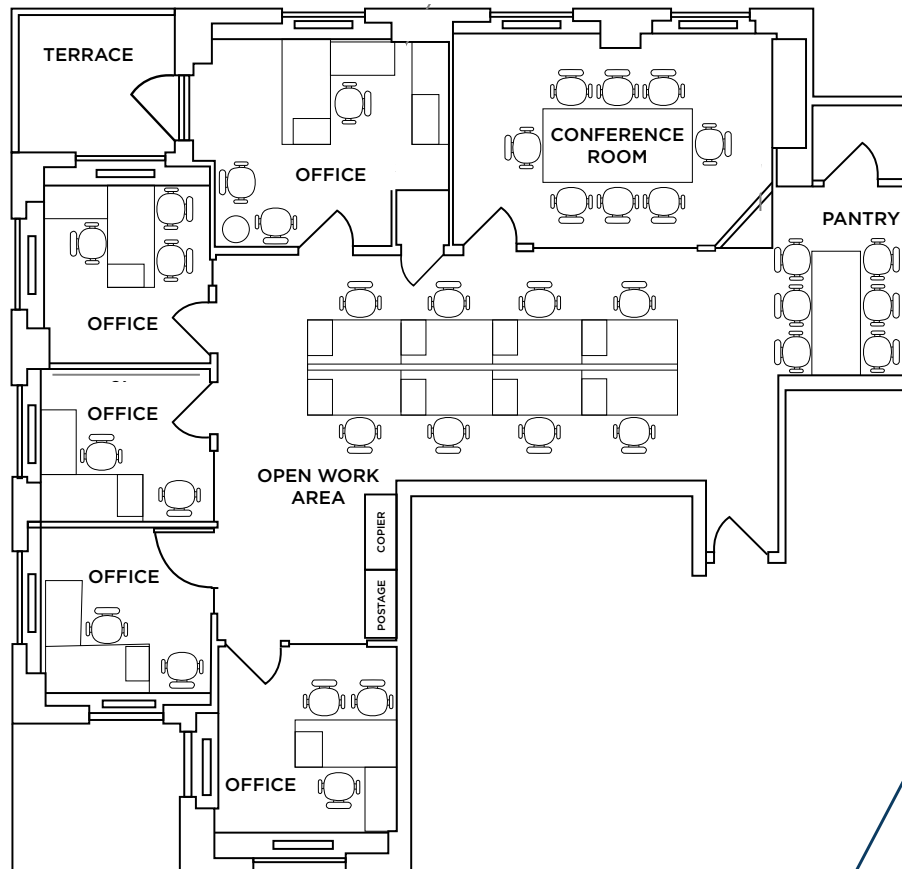

## Layout

- 4 offices
- 1 executive suite with terrace access
- 8 workstations
- 1 pantry







