



277

PARK AVENUE

Between 47th & 48th Streets

Entire 27th Floor

23,163 RSF

High-end Sublease

PARK AVENUE

48TH STREET

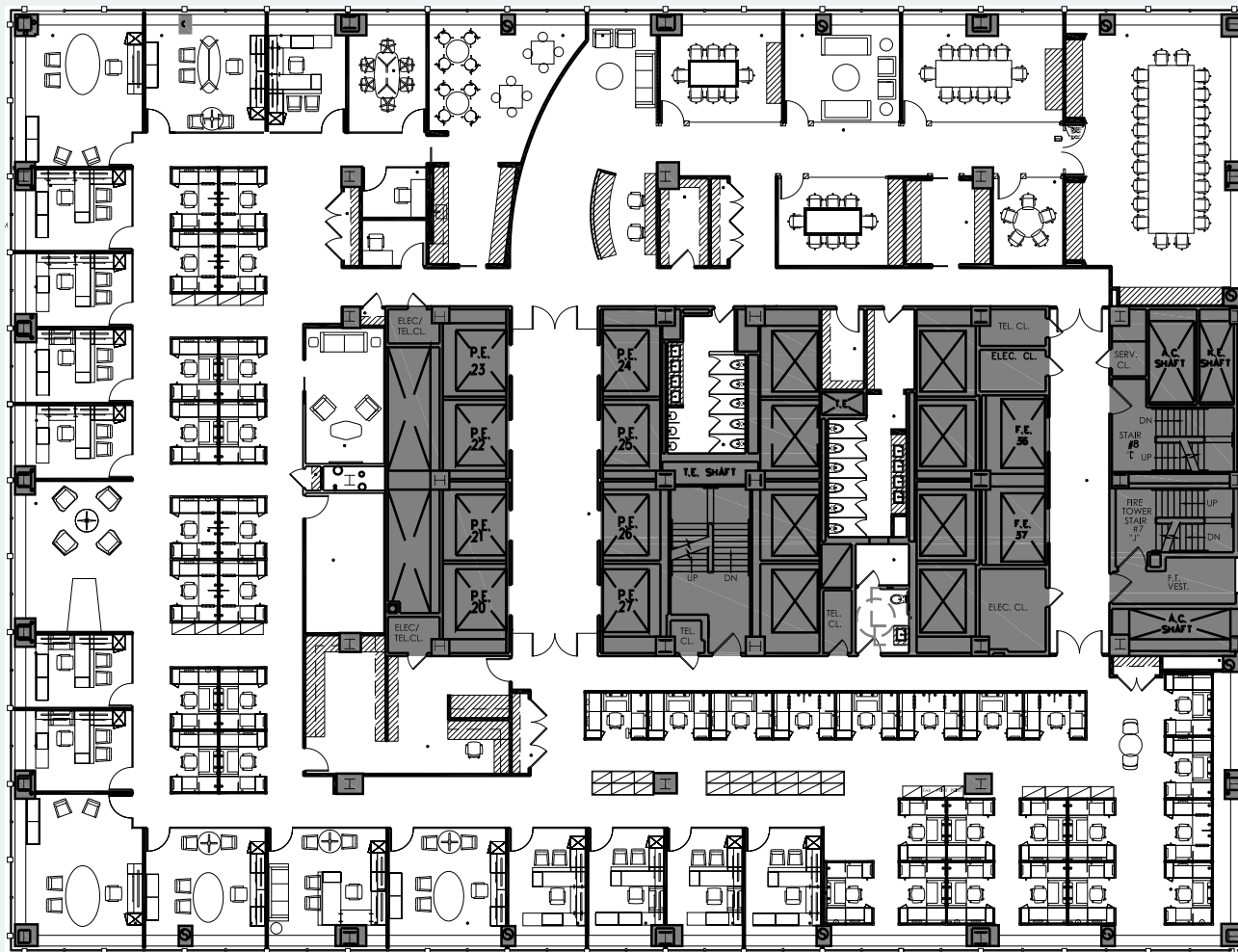

47TH STREET

LEXINGTON AVENUE

ENTIRE 27TH FLOOR

Size: 23,163 RSF
 Term: Through November 29, 2026
 Asking Rent: Upon Request
 Timing: Immediate

- Furniture can be made available
- Move-in condition
- Plug & play full floor sublease opportunity
- New building lobby

Workstations	37	Conference Rooms	5
Offices	19	Board Room	1
Meeting Rooms	2	Wellness Room	1



