

ONE GRAND CENTRAL PLACE

— 60 EAST 42ND STREET —

SUITE 1000 | **39,092** SQ.FT.

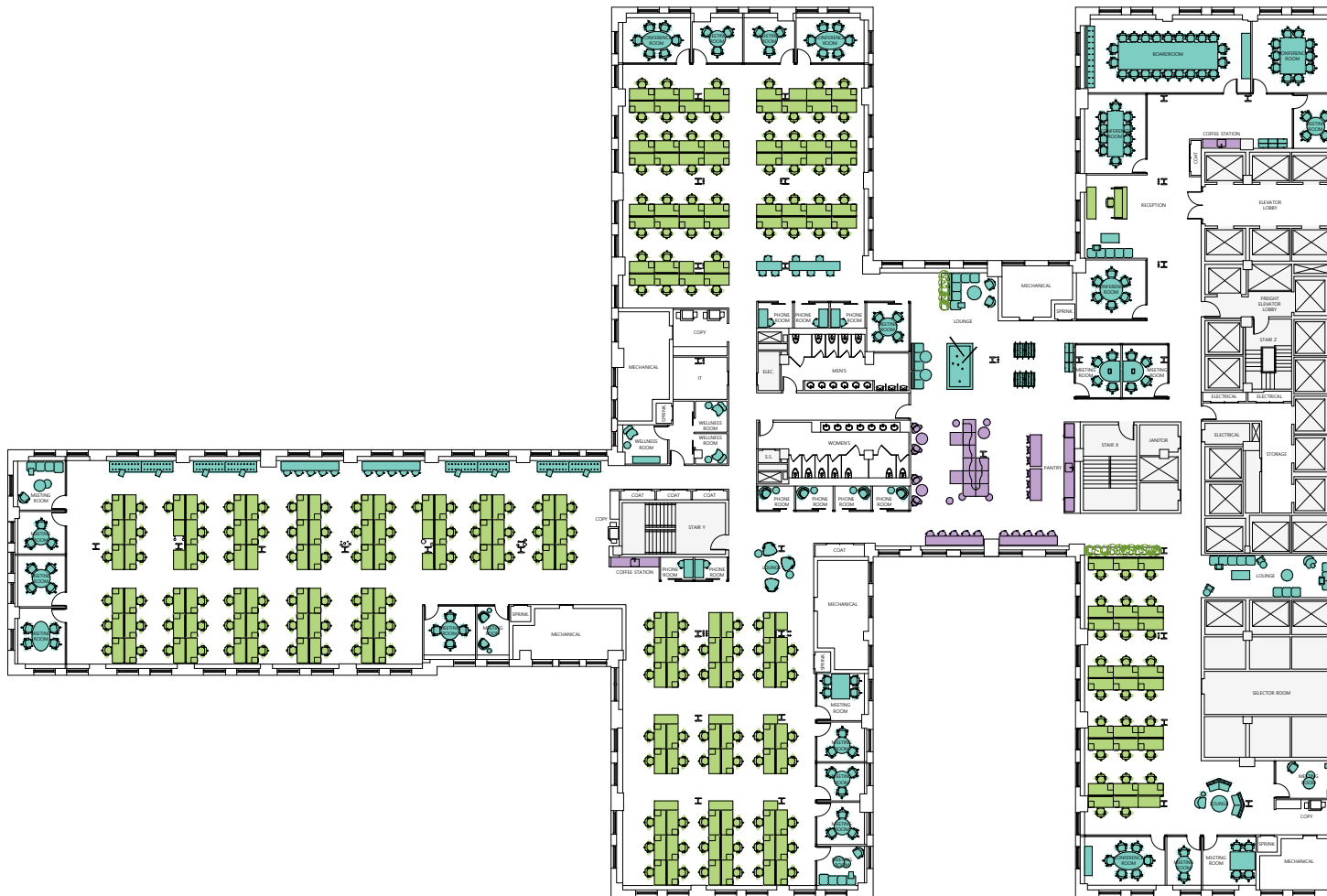

CATEGORY	QTY
Workstation (5'-6" Bench) (Incl. Reception)	199
TOTAL	199
Reception	1
Boardroom	1
Conference Room	6
Meeting Room	20
Phone Room	9
Pantry	1
Coffee Station	2
Copy	3
IT	1
Coat	5
Storage	1
Lounge	4
Wellness Room	3

