

FOR SUBLEASE
PARTIAL 35TH FLOOR
4,277 SF *H.M.*

7 TIMES
SQUARE

NEW YORK, NY



TERM | FEBRUARY 2026

POSSESSION | IMMEDIATE

SPACE HIGHLIGHTS

- Newly built installation
- Fully furnished and wired
- Oversized windows offer great light and views
- Column free layout with 9'6" finished ceiling



BUILDING HIGHLIGHTS

- Modern, institutional quality asset
- New amenity center features food and beverage, collaborative space, and conferencing center
- The building is conveniently located with close proximity to Grand Central Terminal, Penn Station, the Port Authority Bus Terminal, and multiple subway lines including the 1, 2, 3, S, N, Q, R, W, B, D, F, M, and 7 trains.



FLOOR PLAN PARTIAL 35TH FLOOR | 4,277 SF

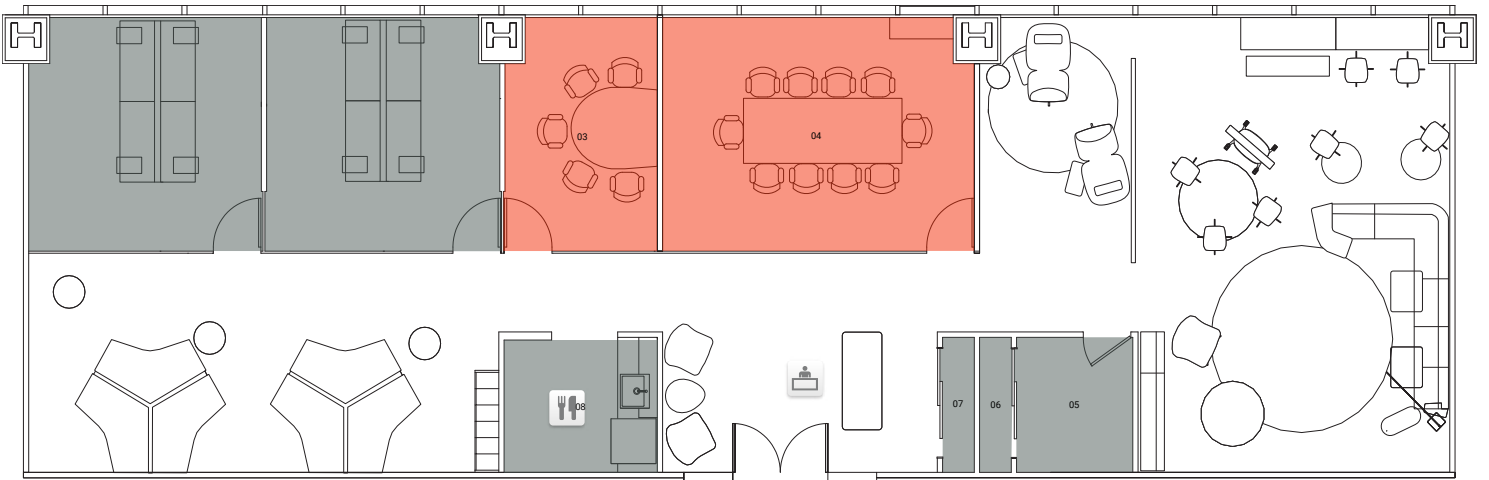



AREA MAP

