



Pristine Corner Office
on the 14th Floor

**420 5TH
AVENUE**

**CENTER LOCATION
OFF BRYANT PARK**



High-End Office Completely Renovated with Excellent Open Floor Plan Layout and Open Views



AVAILABLE WINTER 2023

14TH FLOOR

TOTAL SQ FT: 5237

*Space in Mint Condition
Central Air Conditioning*

Kitchen

*Additional Shared Reception
Shared Conference &
Meeting Room*



SPACE:

Offering a fabulous , eye-catching space at 420 5th Avenue, a Class A building located on the West side of 38th Street and 5th Avenue.

A standout entryway will reveal itself when stepping out of the elevators, high ceilings, floor to ceiling windows, electric blinds and fully equipped kitchen.

BUILDING DESCRIPTION:

420 5th Avenue is one of New York's premier office condominium buildings and the only Class A condominium on 5th Avenue, located a short walk from Bryant Park, Grand Central Penn Plaza and Port Authority. The building offers a dramatic contemporary two story lobby, attended 24/7. The building provides modern systems and first class management. The building boasts a prestigious owner roster including Girl Scouts of America, The Rockefeller Foundation, Helah Bank, Luxottica and more.



420 Fifth Avenue

Midtown South (Between 37th & 38th street)

14TH FLOOR PLAN

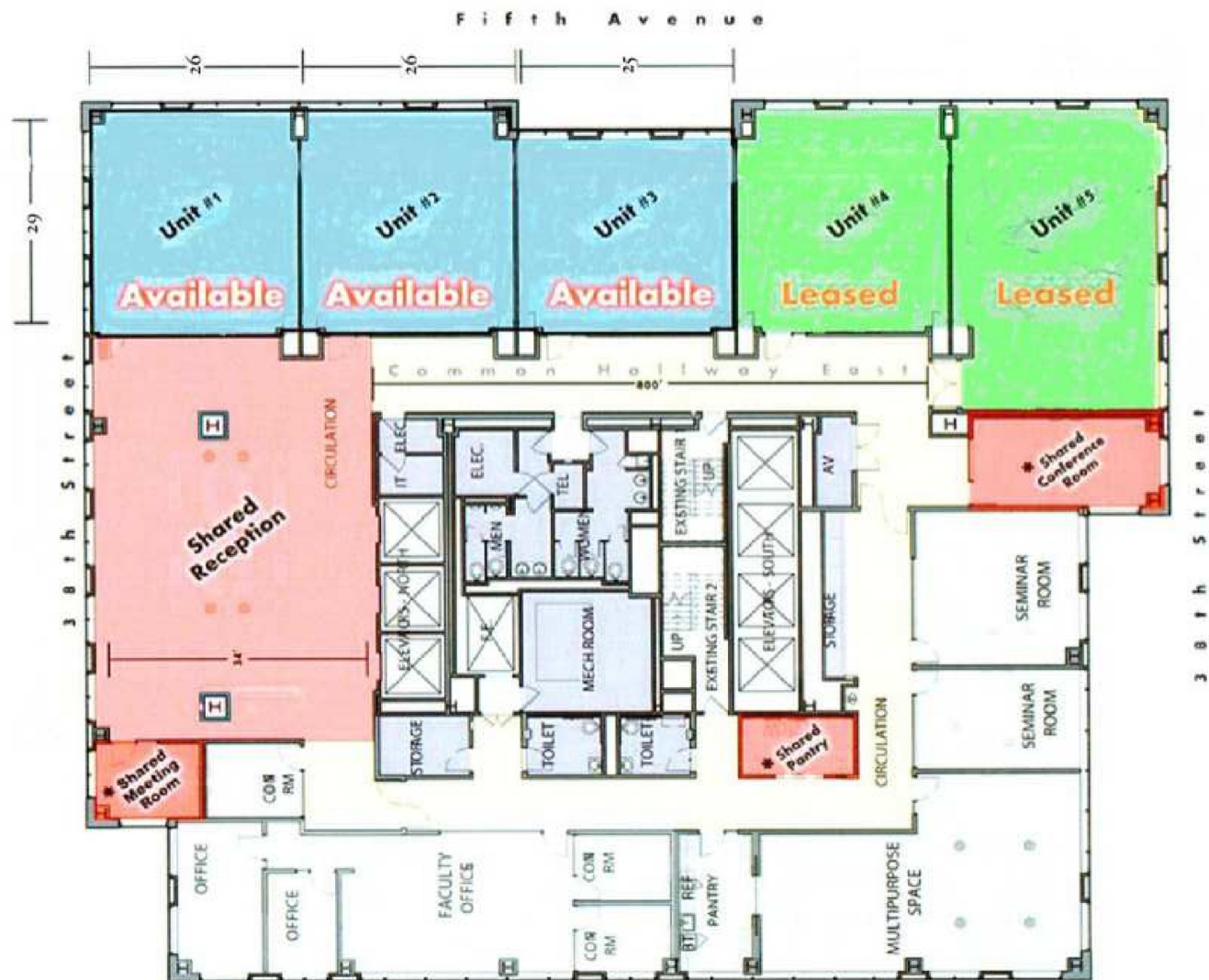

* Common Area for Fifth Avenue Units = 1 to 5