

# 655

T H I R D

PARTIAL  
9<sup>TH</sup> FLOOR  
6,610 RSF

Short-term sublease  
opportunity one block  
from Grand Central



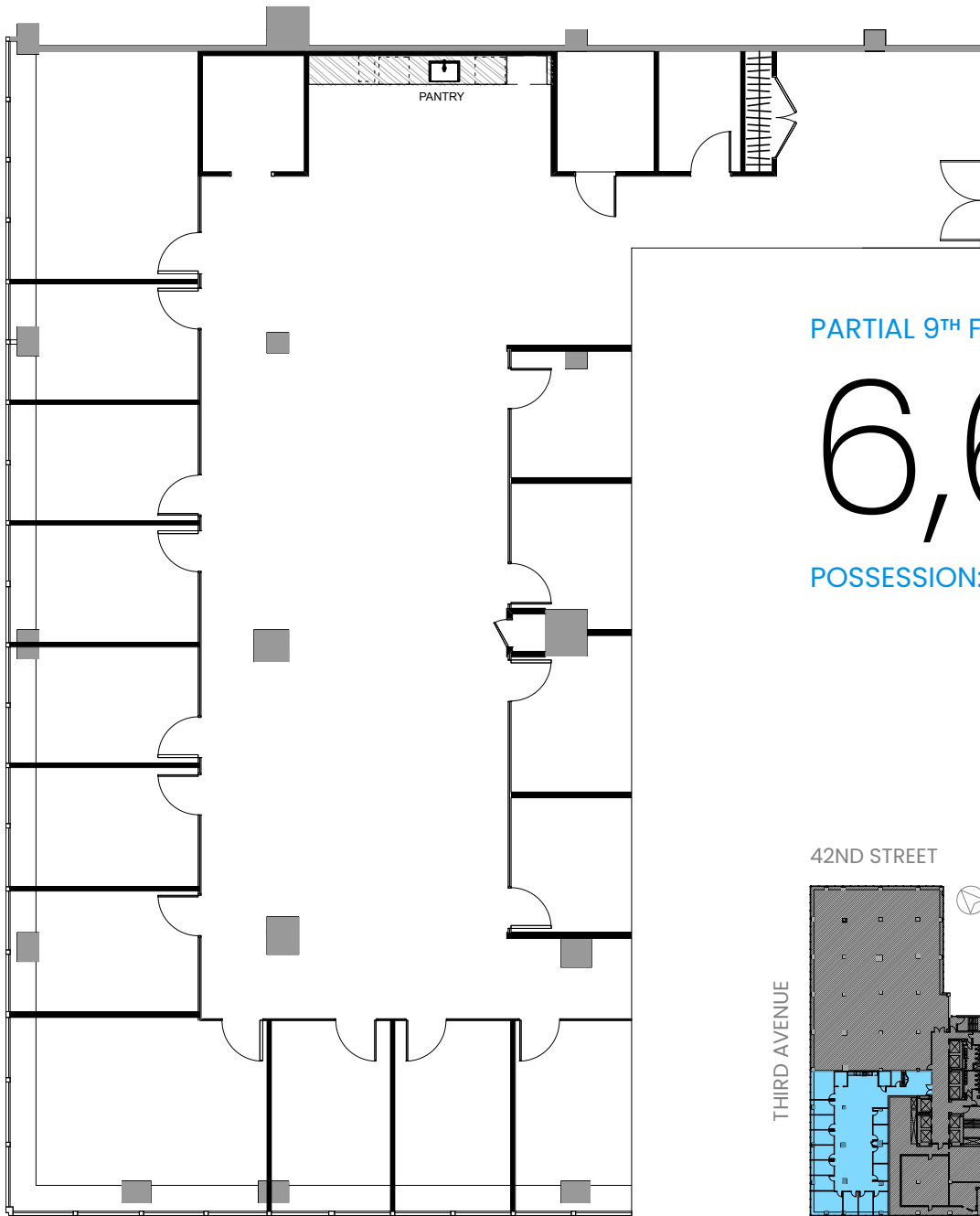

PARTIAL 9<sup>TH</sup> FLOOR

# 6,610 RSF

POSSESSION: IMMEDIATE

TERM: THRU 4/30/2025

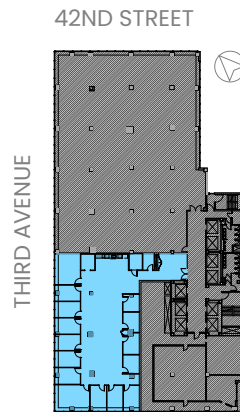

Fully furnished and nicely built space with:

- 9 Windowed offices
- 1 Executive office
- 4 Interior offices
- 1 Large conference room
- 1 Small meeting room/office
- Open area for 10
- Space also features a high-end pantry and reception area







**655**

**T H I R D**