

RISE ABOVE
THE ORDINARY



919th third
ave



OPPORTUNITY HIGHLIGHTS

230,000 RSF TOWER BLOCK

FLOORS 34-35, 40-47

31,000 - 33,000 RSF FULL FLOORS

EFFICIENT CENTER CORE FLOOR PLATES

CONVENIENCE STAIRS CONNECT ALL CONTIGUOUS FLOORS

DEDICATED COOLING TOWER AND EMERGENCY GENERATOR

\$20M REDEVELOPMENT

NEW LOBBY WITH COFFEE BAR

NEW ELEVATOR CABS AND DESTINATION DISPATCH CONTROLS

NEW BIKE ROOM

ON SITE PARKING

ROBUST INFRASTRUCTURE





ELEVATED ENTRANCE EXPERIENCE

The lobby at 919 Third Avenue has been reimagined to elevate the employee and guest experience with hospitality upgrades and a new 19,000 SF open-air plaza. New amenities include a coffee bar, bike room and access from either 55th or 56th Street.



**LOBBY EXTERIOR
CAFE & BIKE ROOM**
ARTIST RENDERING



LOBBY INTERIOR
ARTIST RENDERING



LOBBY INTERIOR
ARTIST RENDERING

SENSE OF ARRIVAL

Employees and guests are welcomed by warm lighting, earth tones and soft furnishings—evoking an understated, luxurious entry experience.





NEW ELEVATOR LOBBY & CABS
ARTIST RENDERING



NEW BATHROOM
ARTIST RENDERING

REIMAGINED LOBBY
AND PLAZA
RENOVATION

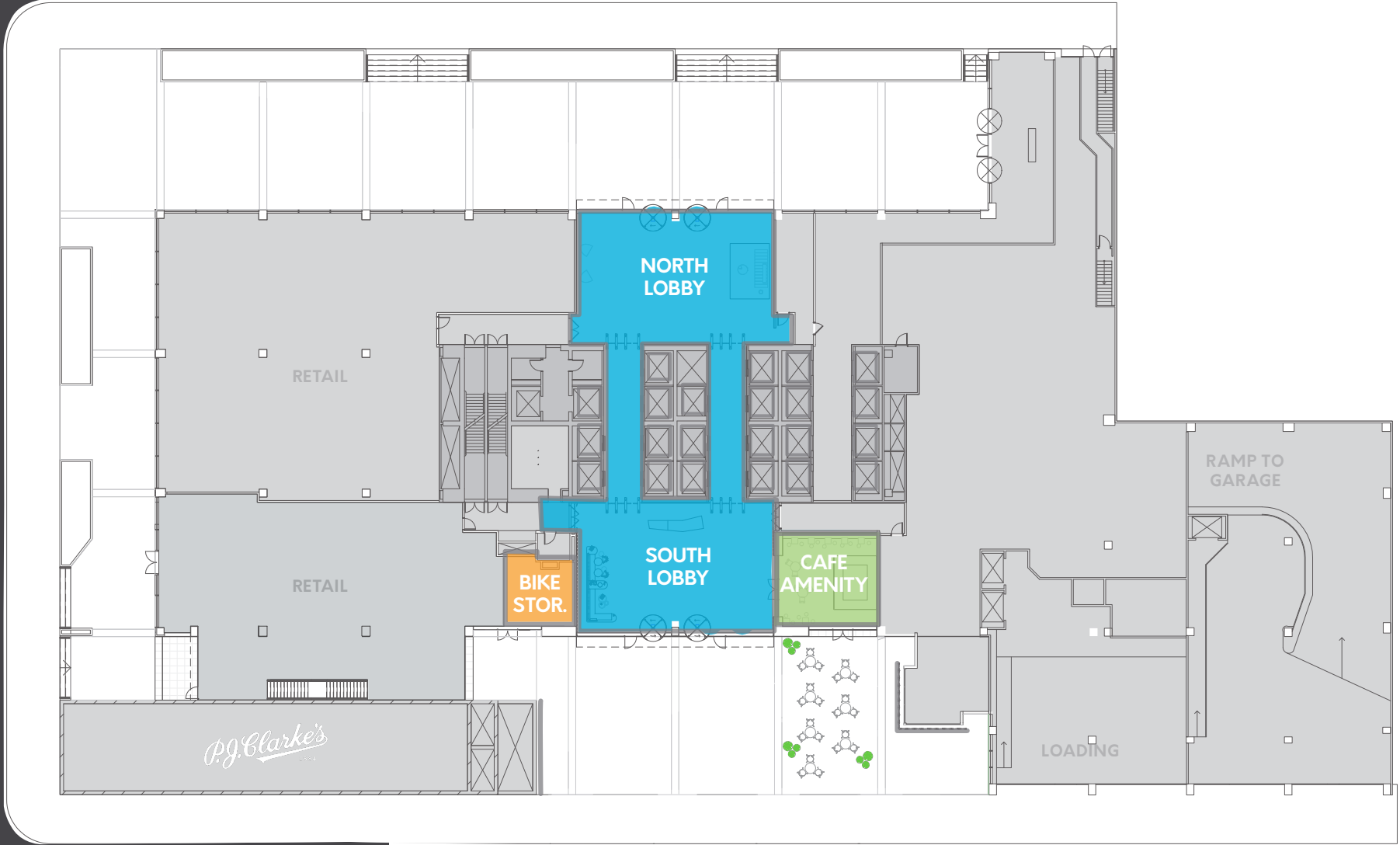



TOWER FLOOR RECEPTION AND VIEWS
ARTIST RENDERING



PRE-BUILT OFFICE
ARTIST RENDERING



OPEN WORKSTATIONS
ARTIST RENDERING



NEW PANTRY
ARTIST RENDERING

BREATHTAKING 360-DEGREE VIEWS

The 230,000 SF block, situated at the top of the tower, enjoys panoramic views over Central Park, the East River and beyond.



PREBUILT

SUITE 4030 - 6,801 RSF



Floor Key

Offices	10
Workstations	17
Conference Rooms	3
Reception	1
Pantry	1
TOTAL PERSONNEL	28

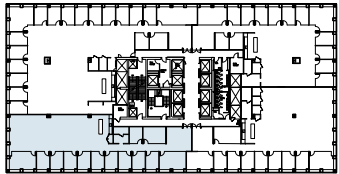

REDISCOVER THE GEMS MIDTOWN HAS TO OFFER

919 Third Avenue is a vibrant workplace destination, situated in a neighborhood with ample dining, shopping and wellness options. Get to Grand Central in 10 minutes via the 6 train or take the E or M to Penn Station or Port Authority in under 15 minutes.

