



# 10 East 40th Street

NEW YORK, NY

---



# 10 East 40th Street at a glance



# Historic Building with Modern Conveniences in Murray Hill

## BUILDING OVERVIEW

Overlooking East 40th Street is the Mercantile Building. This 48-story historic skyscraper is a perfect example of Renaissance Revival architecture—standing as the fourth-tallest building in the world when it was erected in 1929.

# 26th Floor

7,910 RSF

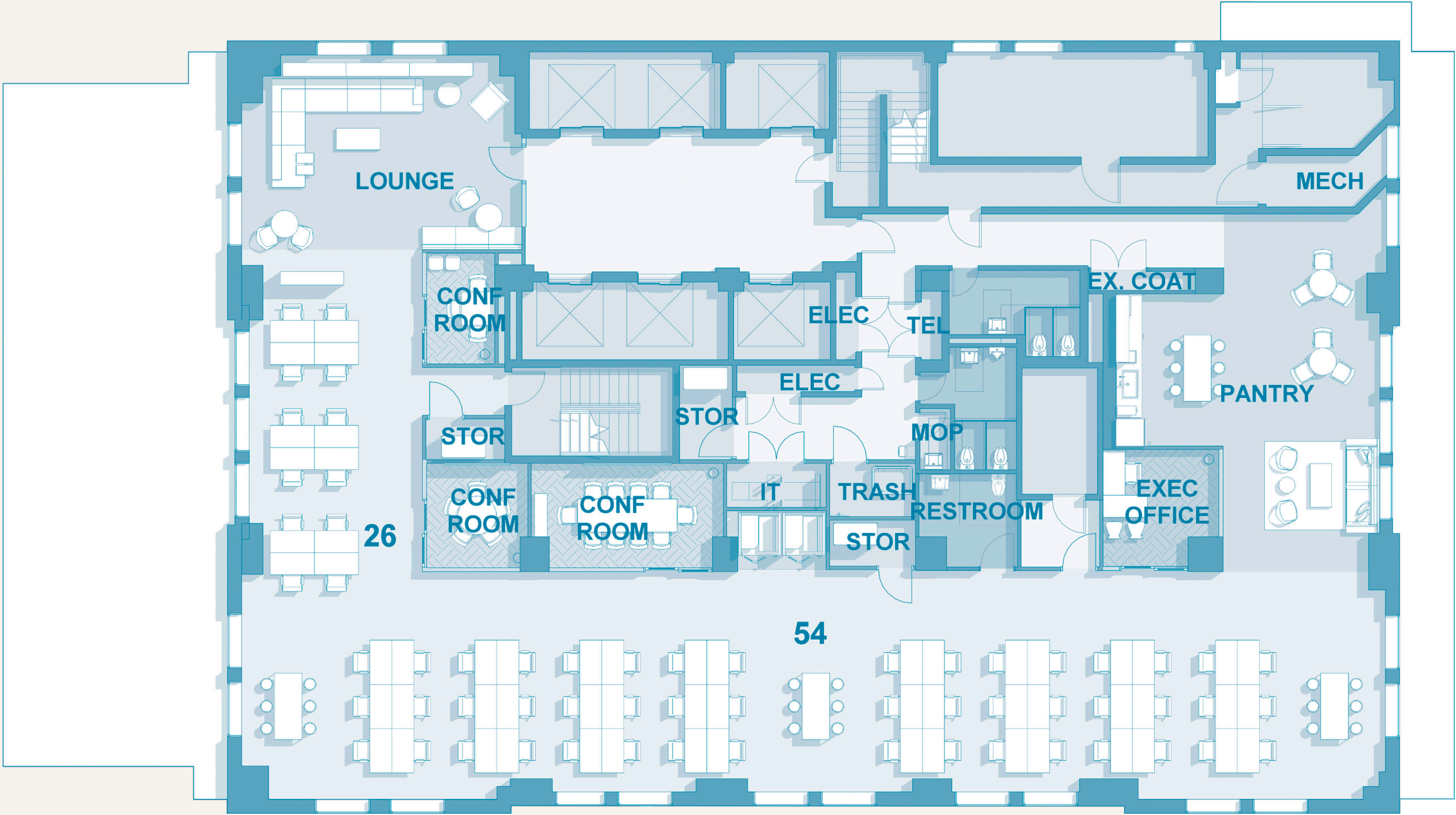





# The city at your doorstep

In the heart of Midtown Manhattan, 10 East 40th Street puts members steps from everything the city has to offer—from the lights of Times Square to the lawns of adjacent Bryant Park and the grandeur of the New York City Public Library. Looking for a place to impress clients or drum up a little post-work inspiration? There are dozens of award-winning restaurants and bars just a stone’s throw from 500 Fifth Ave. Plus, getting here from anywhere in the city couldn’t be simpler with major subway lines steps away, as well as Grand Central Terminal just across the street.



## NEARBY TRANSPORTATION

5th Avenue – Bryant Park (Subway, 7 Lines)	0.1 mi	34th Street-Herald Square (Subway, B, D, F, M, N, Q, R Lines)	0.6 mi
Grand Central-42nd Street (Subway, 4, 5, 6, 7, Shuttle Lines)	0.3 mi	PENN Station (Commuter Rail, New Jersey Transit/LIRR Lines)	0.7 mi
42nd Street-Bryant Park (Subway, B, D, F, M Lines)	0.3 mi	La Guardia Airport	8.9 mi
Grand Central Station (Commuter Rail, Hudson, Harlem, New Haven Lines)	0.3 mi	Newark Liberty International Airport	16.1 mi
33rd Street (Subway, 4, 6 Lines)	0.5 mi	John F. Kennedy International Airport	16.7 mi







10 East 40th  
Street  
New York, NY  
10016

---

