

1114

A V E N U E
O F T H E
A M E R I C A S

PARTIAL 4th FLOOR SUBLEASE
8,034 RSF



PARTIAL 4th FLOOR

8,034 RSF

POSSESSION: APRIL 1, 2024

TERM: 3 YEARS – OCTOBER 30, 2034

COMMENTS:

- Newly built space currently under construction for a April 2024 occupancy
- Layout includes 2 ten-person conference rooms, 1 huddle room, 4 offices / meeting rooms, 1 team room and open area for employee seating
- Furniture available
- Flexible term length
- Trophy building located across the street from Bryant Park
- Within walking distance of multiple subway lines, Grand Central Terminal, Times Square, and Port Authority

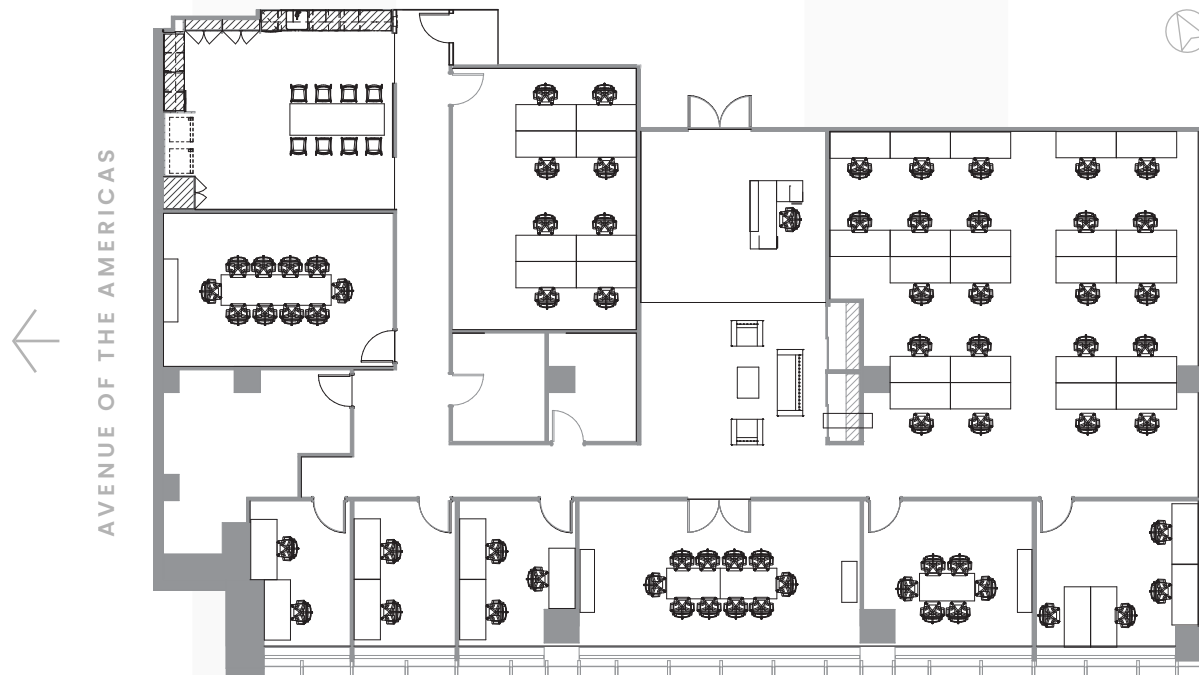

WEST 42ND STREET
VIEWS OF BRYANT PARK



1114

A V E N U E
O F T H E
A M E R I C A S

THE GRACE BUILDING